

Technická zpráva

Zaměření stávajícího stavu pro projekt

Název prací: „III/3626: Olešnice – Trpín, hr. Pardubického kraje“

Investor: SÚSJMK, p.o.

Zadavatel: Dopravoprojekt Ostrava a.s.

Název lokality: Sil. III/3626: Olešnice – Trpín, hr. Pardubického kraje

Kraj: Jihomoravský, Pardubický

Okres: Boskovice, Polička

Katastrální území: Olešnice na Moravě (710415), Trpín (768740),
Kněževes (666882)

Měřítko: 1: 5000; 1000

Číslo zakázky: 2023014

Souř. systém: S-JTSK

Výšk. systém: Bpv

Vypracoval: Ing. Petr Hrbáč,  -geodetická kancelář

ÚOZI: Ing. Petr Hrbáč – položka seznamu ČÚZK č. 2545/11

březen 2023

1. Použité přístroje:

- Totální stanice: TRIMBLE SPS 930(s.n.72613163), trojpodstavcová souprava
- GNSS stanice Trimble SPS986 (s.n.6213F01100)
- Grafická linka: PC AT
- Plotter: Canon iPF605
- Tiskárna: Canon i-SENSYS MF735Cx

2. Použitý software:

- GEUS W 17.0
- MicroStation PowerMap 08.09.04.82
- Trimble Business Center v. 5.80

3. Údaje o použitých podkladech

Jako podklady pro geodetické měření sloužil snímek s vyznačením lokality a rekognoscace terénu na místě samém. Úkolem geodetických prací bylo zaměření stávajícího stavu silnice III/3626: Olešnice – Trpín, hr. Pardubického kraje.

4. Přesnost měření

Charakteristikou přesnosti polohopisu a výškopisu je pro zpevněný povrch $m_{xy}=0,03\text{m}$, $m_h=0,03\text{m}$, pro nezpevněný povrch $m_{xy}=0,10\text{m}$, $m_h=0,10\text{m}$ a pro vybrané objekty technické infrastruktury $m_{xy}<0,03\text{m}$, $m_h<0,015\text{m}$

5. Podrobné polohové a výškové bodové pole

Připojení na souřadnicový systém bylo provedeno GNSS aparaturou Trimble SPS986, která byla napojena na síť permanentních stanic pro určování polohy TRIMBLE VRS Now. Byl použit globální kalibrační klíč, ze kterého se zaměřily body 4001–4011(viz příloha č.1). Byl použit souřadnicový systém S-JTSK a výškový systém Bpv.

2

6. Popis prací

Zaměření proběhlo dne 25. 02. 2023. Měření bylo provedeno polární metodou s kombinací GNSS RTK metodou. Měřil se stávající stav dané lokality, hrany komunikace, osa, hrany svahu, viditelné inženýrské sítě, dopravní značky apod. Z tohoto zaměření se vyhotovil polohopisný a výškopisný plán.

Zpracované zaměření v digitální podobě bylo předáno objednateli. Všechny výpočty jsou uloženy u zpracovatele.

V digitální podobě byly předány tyto soubory

- | | |
|------------------------------|--------------------------------|
| – 2023014.dgn (dwg) | zaměření, polohopis a výškopis |
| – 2023014_km.dgn (dwg) | digitální katastrální mapa |
| – 2023014.txt (xlsx)..... | seznam souřadnic měřených bodů |
| – 2023014.pdf | celkový elaborát |

Grafický elaborát obsahuje:

- technickou zprávu
- seznam souřadnic bodů PBPP (příloha č.1)
- seznam souřadnic měřených bodů (příloha č.2)
- situace celková (M 1:5000)
- situace č.1-3(M1:1000) polohopisný a výškopisný plán, soutisk s katastrální mapou

7. Zákony, normy, předpisy

- Zákon 200/1994 Sb. – Zeměměřický zákon
- Vyhláška 31/1995 – ČUZK, kterou se provádí Zákon 200/1994 Sb.
- ČSN 01 3411 Mapy velkých měřítek: Kreslení a značky
- ČSN 73 0415 Geodetické body
- Vyhláška 30/2001 Sb., kterou se provádějí pravidla provozu na pozemních komunikacích a úprava a řízení provozu na pozemních komunikacích, ve znění pozdějších předpisů
- Vyhláška 104/1997 Sb., kterou se provádí zákon o pozemních komunikacích, ve znění pozdějších předpisů
- Zákon 13/1997 Sb. O pozemních komunikacích, ve znění pozdějších předpisů.

IGH - geodetická kancelář
Ing. Petr Hrbáč
756 51 Zašová 710
IČ 69605343 DIČ CZ7510044135
tel. 603 864 585 603 751 288

Vypracoval dne:

Ing. Petr Hrbáč

Příloha č.1: Podrobné polohové a výškové bodové pole

č.b.	Y	X	Z	popis
4001	607219.58	1116409.35	587.80	nastřelovací hřeb
4002	607147.41	1116620.09	603.91	nastřelovací hřeb
4003	607150.29	1116847.75	602.09	nastřelovací hřeb
4004	607237.5	1117020.23	593.69	nastřelovací hřeb
4005	607345.44	1117305.08	589.47	nastřelovací hřeb
4006	607343.48	1117524.25	598.22	nastřelovací hřeb
4007	607304.97	1117719.98	595.36	nastřelovací hřeb
4008	607240.16	1117888.31	590.99	nastřelovací hřeb
4009	607208.25	1118158.37	580.14	nastřelovací hřeb
4010	607133.36	1118799.44	563.60	nastřelovací hřeb
4011	607112.61	1118897.34	559.41	nastřelovací hřeb

č.bodu	Y	X	Z	popis	č.bodu	Y	X	Z	popis
1	607303.43	1116320.34	583.80	ZNACKA	84	607167.04	1116464.10	591.56	BET
2	607309.70	1116325.09	583.90	ZNACKA	85	607164.37	1116466.08	591.65	BET
3	607310.85	1116322.32	583.98		86	607163.99	1116465.59	591.54	NZP
4	607310.61	1116322.02	583.99	XAC	87	607163.93	1116465.59	591.54	NZP
5	607308.76	1116320.44	584.06		88	607163.41	1116464.71	591.50	HH
6	607306.81	1116318.57	583.89	XBET	89	607160.73	1116465.69	591.59	HH
7	607306.26	1116318.05	583.76		90	607160.99	1116467.08	591.62	NZP
8	607298.54	1116324.43	584.13		91	607161.33	1116467.77	591.75	BET
9	607299.41	1116325.18	584.09		92	607158.93	1116468.69	591.77	BET
10	607299.94	1116325.74	584.19	BET	93	607158.70	1116467.72	591.61	NZP
11	607301.58	1116327.62	584.30		94	607158.13	1116466.16	591.57	HH
12	607303.34	1116329.92	584.28	AC	95	607155.28	1116466.39	591.48	HH
13	607304.11	1116330.96	584.05		96	607154.92	1116468.08	591.54	NZP
14	607291.52	1116343.80	584.55	XSS	97	607154.89	1116468.96	591.75	BET
15	607290.83	1116343.35	584.70	XVS	98	607151.79	1116468.52	591.69	BET
16	607290.50	1116343.21	584.76	AC	99	607151.97	1116467.76	591.54	NZP
17	607289.06	1116347.01	584.76	ZNACKA	100	607152.19	1116466.62	591.22	HH
18	607287.03	1116343.00	584.96		101	607155.84	1116469.58	591.82	
19	607284.85	1116341.38	584.84	BET	102	607149.26	1116472.10	591.96	
20	607284.00	1116341.09	584.70		103	607152.90	1116476.52	592.37	
21	607283.47	1116340.52	584.72	XHH	104	607155.69	1116482.04	592.87	
22	607265.71	1116358.22	585.42	HH	105	607155.25	1116473.79	592.23	
23	607266.64	1116359.06	585.49		106	607159.11	1116473.20	592.22	
24	607267.10	1116359.71	585.62	BET	107	607168.92	1116462.95	591.46	XNEJ
25	607268.73	1116361.67	585.70		108	607166.54	1116465.85	591.68	NEJ
26	607270.42	1116364.12	585.68	AC	109	607164.69	1116468.20	591.87	NEJ
27	607270.92	1116364.84	585.60		110	607166.96	1116470.29	591.90	
28	607271.15	1116365.28	585.72		111	607169.86	1116472.40	591.67	AC
29	607254.12	1116382.38	586.56		112	607170.39	1116472.69	591.61	SS
30	607253.73	1116382.19	586.35	XSS	113	607168.09	1116476.82	591.94	SS
31	607253.28	1116381.85	586.38	AC	114	607167.72	1116476.72	591.97	AC
32	607251.02	1116380.22	586.45		115	607164.36	1116475.45	592.22	
33	607249.00	1116378.37	586.35	BET	116	607161.67	1116474.22	592.34	NEJ
34	607247.63	1116377.30	586.21	HH	117	607159.56	1116478.90	592.69	NEJ
35	607233.14	1116393.03	586.88	HH	118	607162.11	1116480.02	592.60	
36	607230.22	1116394.79	587.14	HH	119	607165.40	1116481.36	592.35	AC
37	607228.54	1116395.49	587.17	HH	120	607165.88	1116481.70	592.33	SS
38	607230.43	1116396.43	587.09		121	607164.17	1116486.82	592.76	SS
39	607230.98	1116397.13	587.19	BET	122	607163.47	1116486.55	592.83	AC
40	607232.73	1116399.01	587.31		123	607160.81	1116486.01	593.04	
41	607234.76	1116401.21	587.22	AC	124	607157.74	1116484.77	593.16	NEJ
42	607235.29	1116401.99	587.41	ZNACKA	125	607156.60	1116489.69	593.52	NEJ
43	607234.80	1116401.90	587.22	SS	126	607159.19	1116490.61	593.48	
44	607234.90	1116402.87	587.51		127	607162.32	1116491.10	593.27	AC
45	607223.59	1116415.48	588.15		128	607162.67	1116491.31	593.23	XVS
46	607224.54	1116413.68	588.02	ZNACKA	129	607163.29	1116491.51	593.18	SS
47	607223.22	1116414.50	587.90	SS	130	607162.28	1116497.67	593.82	SS
48	607222.74	1116414.02	587.91	AC	131	607161.75	1116497.50	593.91	VS
49	607220.46	1116412.40	587.99		132	607161.28	1116497.47	593.97	AC
50	607218.40	1116410.41	587.84	BET	133	607158.71	1116497.43	594.10	
51	607217.64	1116409.86	587.78		134	607155.83	1116496.13	593.97	NEJ
52	607216.36	1116408.86	587.70	HH	135	607150.13	1116482.15	592.55	XBET
53	607199.52	1116426.12	588.64	HH	136	607149.45	1116482.53	592.49	XNZP
54	607199.97	1116426.67	588.91		137	607150.93	1116484.93	592.70	NZP
55	607200.89	1116427.51	588.69		138	607151.56	1116484.84	592.78	BET
56	607201.45	1116428.02	588.81	BET	139	607153.20	1116488.03	593.08	BET
57	607203.41	1116429.94	588.98		140	607152.67	1116488.32	593.07	NZP
58	607205.22	1116432.06	588.91	AC	141	607153.89	1116491.77	593.48	NZP
59	607205.33	1116432.56	588.92	SS	142	607154.40	1116491.90	593.52	BET
60	607206.12	1116432.80	589.11	ZNACKA	143	607154.94	1116495.34	593.88	BET
61	607206.31	1116434.30	589.26		144	607154.67	1116495.41	593.87	NZP
62	607190.46	1116450.25	590.18		145	607154.93	1116497.47	594.11	NZP
63	607189.56	1116449.43	589.82	SS	146	607155.15	1116497.37	594.04	BET
64	607189.11	1116449.07	589.91	AC	147	607155.58	1116497.37	594.07	BET NEJ
65	607186.59	1116447.09	590.01		148	607153.19	1116505.23	594.89	
66	607184.75	1116445.23	589.89	BET	149	607154.61	1116505.64	594.97	BET
67	607183.91	1116444.64	589.69		150	607157.61	1116505.82	594.99	
68	607182.46	1116443.49	589.67	HH	151	607160.39	1116506.42	594.97	AC
69	607173.63	1116454.80	590.42	HH	152	607160.93	1116506.61	594.93	VS
70	607174.43	1116455.41	590.72	XHOR	153	607161.56	1116506.85	594.81	SS
71	607174.95	1116455.79	590.79	BET	154	607159.85	1116522.36	596.34	SS
72	607176.79	1116457.54	590.83		155	607159.48	1116522.27	596.51	VS
73	607179.26	1116459.63	590.68	AC	156	607159.00	1116522.26	596.55	AC
74	607179.67	1116460.34	590.57	SS	157	607156.11	1116522.33	596.60	
75	607180.80	1116461.24	591.22		158	607152.90	1116522.18	596.45	BET
76	607175.23	1116465.55	591.07	SS	159	607151.01	1116522.10	596.15	
77	607174.52	1116465.12	591.16	AC	160	607148.78	1116543.25	597.87	
78	607172.29	1116462.94	591.32		161	607150.02	1116544.20	598.52	ZNACKA XHOR
79	607170.30	1116461.18	591.29	BET	162	607151.14	1116543.65	598.45	BET
80	607169.71	1116460.72	591.24	HOR XNZP	163	607153.96	1116543.76	598.50	
81	607168.74	1116460.29	591.07	HH	164	607157.18	1116544.37	598.42	AC
82	607166.11	1116462.86	591.17	HH	165	607157.56	1116544.45	598.43	VS
83	607166.54	1116463.79	591.46	NZP	166	607158.13	1116544.60	598.24	SS

č.bodu	Y	X	Z	popis	č.bodu	Y	X	Z	popis
167	607156.86	1116564.27	599.95	SS	250	607140.73	1116806.13	603.88	
168	607156.47	1116564.25	600.11	VS	251	607141.43	1116818.70	603.36	
169	607155.80	1116564.23	600.17	AC	252	607142.98	1116818.80	603.41	BET
170	607152.72	1116564.33	600.30		253	607145.61	1116818.80	603.29	
171	607149.83	1116564.40	600.17	BET	254	607148.79	1116818.74	603.09	AC
172	607148.09	1116564.14	599.95	HOR	255	607149.28	1116818.71	603.04	VS
173	607146.62	1116564.20	599.55		256	607149.81	1116818.97	602.88	SS
174	607145.86	1116578.44	600.81		257	607151.91	1116831.00	602.40	SS VS
175	607147.80	1116578.06	601.27	HOR ZNACKA	258	607151.08	1116831.24	602.48	AC
176	607148.91	1116577.80	601.33	BET	259	607148.24	1116832.24	602.67	
177	607152.07	1116577.77	601.45		260	607145.51	1116832.86	602.81	BET
178	607154.99	1116577.88	601.32	AC	261	607143.55	1116833.11	602.69	
179	607155.54	1116577.96	601.30	VS	262	607146.07	1116841.79	602.50	
180	607156.06	1116578.36	601.26	SS	263	607147.75	1116841.23	602.48	BET
181	607155.23	1116597.47	602.58	SS	264	607150.46	1116840.55	602.28	
182	607154.58	1116597.35	602.77	VS	265	607153.27	1116839.55	602.13	AC
183	607153.93	1116597.30	602.79	AC	266	607154.20	1116839.24	602.04	SS
184	607150.74	1116597.38	602.85		267	607158.90	1116852.16	601.42	SS XVS
185	607148.09	1116597.33	602.78	BET	268	607157.82	1116852.27	601.58	AC
186	607146.64	1116597.44	602.68	HOR	269	607155.25	1116853.47	601.66	
187	607145.94	1116619.79	603.76	HOR	270	607152.50	1116854.37	601.68	BET
188	607147.26	1116619.90	603.87	BET	271	607150.82	1116854.93	601.69	
189	607150.06	1116619.94	603.96		272	607157.18	1116870.38	601.01	
190	607152.98	1116620.08	603.89	AC	273	607158.40	1116869.75	600.88	BET
191	607153.78	1116619.71	604.02	VS SS	274	607160.98	1116868.19	601.00	
192	607153.63	1116616.65	603.79	XNEJ	275	607163.65	1116866.88	600.91	AC
193	607154.60	1116617.37	603.94	NEJ	276	607164.07	1116866.89	600.82	VS
194	607156.60	1116617.99	603.95	NEJ	277	607164.64	1116867.04	600.78	SS
195	607157.00	1116623.25	603.97	XNEJ	278	607172.05	1116885.69	599.92	SS
196	607155.17	1116623.65	604.03	NEJ	279	607171.60	1116886.16	600.09	VS
197	607153.82	1116624.32	603.92	NEJ XSS	280	607171.25	1116886.34	600.13	AC
198	607152.95	1116625.57	604.07	AC	281	607168.78	1116887.31	600.17	
199	607153.26	1116626.20	604.05	XVS	282	607165.99	1116888.84	600.02	BET
200	607149.81	1116626.00	604.17		283	607164.54	1116889.62	600.04	
201	607147.05	1116625.98	604.09	BET	284	607174.48	1116915.61	598.82	
202	607145.61	1116626.36	603.96		285	607176.07	1116915.50	598.75	BET
203	607145.48	1116645.51	604.69		286	607178.84	1116914.62	598.84	
204	607146.30	1116645.63	604.69	BET	287	607181.73	1116913.96	598.73	AC
205	607149.06	1116645.95	604.77		288	607182.17	1116913.93	598.70	VS
206	607152.04	1116646.42	604.71	AC	289	607182.80	1116913.78	598.53	SS
207	607152.79	1116646.59	604.69	VS	290	607192.48	1116938.66	597.14	SS
208	607153.44	1116646.76	604.51	SS	291	607191.88	1116939.08	597.29	VS
209	607152.55	1116669.52	605.19	SS	292	607191.57	1116939.23	597.36	AC
210	607151.81	1116669.63	605.35	VS	293	607188.92	1116940.47	597.43	
211	607151.27	1116669.68	605.41	AC	294	607186.26	1116941.76	597.31	BET
212	607148.75	1116669.79	605.50		295	607185.08	1116942.79	597.15	
213	607145.48	1116670.08	605.45	BET	296	607193.75	1116966.33	596.21	
214	607144.06	1116670.37	605.52		297	607195.51	1116966.03	596.15	BET
215	607143.61	1116695.49	606.13		298	607198.20	1116965.19	596.27	
216	607144.81	1116695.93	606.01	BET	299	607200.97	1116964.59	596.14	AC
217	607147.52	1116696.07	606.08		300	607201.30	1116964.57	596.10	VS
218	607150.48	1116696.42	606.03	AC	301	607202.02	1116964.48	595.94	SS
219	607150.96	1116696.73	605.94	VS	302	607211.56	1116989.11	594.69	SS
220	607151.77	1116697.08	605.74	SS	303	607211.01	1116989.30	594.86	VS
221	607151.26	1116717.70	605.87	SS	304	607210.61	1116989.40	594.88	AC
222	607150.37	1116718.00	606.09	VS	305	607208.21	1116990.48	594.97	
223	607149.94	1116718.10	606.18	AC	306	607205.43	1116991.46	594.89	BET
224	607147.29	1116718.07	606.28		307	607203.86	1116992.04	594.91	
225	607144.34	1116718.39	606.18	BET	308	607213.93	1117017.54	593.55	
226	607143.00	1116718.78	606.23		309	607214.91	1117017.31	593.61	BET
227	607141.66	1116742.68	605.83		310	607217.25	1117015.89	593.73	
228	607143.74	1116743.13	605.76	BET	311	607220.24	1117014.73	593.67	AC
229	607146.69	1116743.33	605.84		312	607220.59	1117014.96	593.63	VS
230	607149.32	1116743.66	605.72	AC	313	607220.97	1117014.74	593.56	SS
231	607149.90	1116743.77	605.66	VS	314	607231.29	1117041.67	592.24	SS
232	607150.76	1116744.09	605.39	SS	315	607230.87	1117041.94	592.33	VS
233	607150.03	1116768.80	604.83	SS	316	607230.54	1117042.00	592.38	AC
234	607149.21	1116769.14	604.97	VS	317	607227.87	1117043.19	592.47	
235	607148.62	1116769.07	605.05	AC	318	607225.17	1117044.01	592.41	BET
236	607146.03	1116769.14	605.14		319	607224.10	1117044.34	592.31	
237	607142.98	1116768.89	605.08	BET	320	607233.58	1117069.09	590.94	
238	607141.80	1116768.95	605.08		321	607234.18	1117068.84	591.16	XHOR
239	607140.89	1116786.62	604.57		322	607234.44	1117068.66	591.21	BET
240	607142.54	1116787.10	604.59	BET	323	607236.94	1117067.78	591.26	
241	607145.26	1116787.08	604.61		324	607239.78	1117067.03	591.10	AC
242	607148.28	1116787.32	604.49	AC	325	607240.06	1117066.91	591.06	VS
243	607148.99	1116787.43	604.41	VS	326	607240.52	1117066.83	590.99	SS
244	607149.46	1116787.56	604.19	SS	327	607248.88	1117088.72	589.81	SS
245	607149.59	1116805.40	603.58	SS	328	607248.29	1117088.94	589.88	AC VS
246	607148.58	1116805.54	603.79	VS	329	607245.82	1117090.44	590.02	
247	607148.06	1116805.49	603.81	AC	330	607243.16	1117091.45	589.96	BET
248	607145.49	1116805.72	603.91		331	607242.68	1117091.53	589.94	HOR
249	607142.29	1116805.98	603.98	BET	332	607242.21	1117091.75	589.79	

č.bodu	Y	X	Z	popis	č.bodu	Y	X	Z	popis
333	607247.34	1117105.48	589.18		416	607280.62	1117200.44	585.11	XBET
334	607247.77	1117105.39	589.26	HOR	417	607283.05	1117200.46	585.09	BET
335	607248.14	1117105.17	589.28	BET	418	607285.61	1117200.78	585.06	BET
336	607250.69	1117104.18	589.33		419	607287.51	1117201.28	585.05	BET
337	607253.44	1117102.82	589.22	AC	420	607288.84	1117201.94	585.02	BET
338	607254.11	1117102.67	589.13	SS	421	607289.99	1117202.58	584.94	BET
339	607263.17	1117124.61	587.83	SS	422	607291.11	1117203.59	584.98	BET
340	607262.74	1117125.26	587.91	AC XVS	423	607293.12	1117207.85	584.97	BET
341	607260.02	1117126.40	588.04		424	607291.48	1117207.23	584.92	ZNACKA
342	607257.14	1117127.66	587.93	BET	425	607289.83	1117203.43	584.91	XDUM XBZD
343	607256.42	1117128.11	587.84		426	607289.93	1117203.16	584.96	DUM
344	607255.82	1117128.31	587.91		427	607287.82	1117201.84	585.01	DUM
345	607284.83	1117180.16	585.34	VRTV	428	607284.92	1117201.58	584.99	DUM
346	607268.43	1117136.74	587.03	SS	429	607284.90	1117201.89	584.97	DUM
347	607267.98	1117137.17	587.18	VS	430	607287.61	1117202.16	584.97	DUM BZD
348	607267.67	1117137.34	587.27	AC	431	607287.43	1117202.72	583.89	KKAN XDLN
349	607265.29	1117138.61	587.31		432	607290.24	1117203.99	584.86	XHOR
350	607262.48	1117139.96	587.23	BET	433	607291.52	1117206.93	584.84	HOR
351	607261.84	1117140.31	587.20		434	607293.77	1117211.91	584.66	HOR
352	607260.73	1117141.05	587.34		435	607294.39	1117213.67	584.67	HOR
353	607264.66	1117152.04	586.52		436	607296.12	1117216.02	584.83	HOR
354	607266.01	1117151.99	586.37	XDLN	437	607290.13	1117208.80	584.10	
355	607266.69	1117151.84	586.46	XHOR	438	607291.49	1117211.57	584.09	
356	607267.47	1117151.72	586.49	BET	439	607292.20	1117213.32	583.90	
357	607270.15	1117150.78	586.55		440	607288.90	1117208.70	583.69	DLN
358	607272.88	1117149.95	586.48	AC	441	607288.61	1117210.25	583.54	DLN
359	607273.55	1117149.86	586.36	VS	442	607289.45	1117212.13	583.55	DLN
360	607274.10	1117149.69	586.15	SS	443	607289.79	1117214.02	583.43	DLN
361	607281.08	1117165.23	585.36	SS	444	607290.85	1117215.36	583.45	DLN
362	607280.32	1117165.61	585.62	VS	445	607292.08	1117215.03	583.43	DLN
363	607279.87	1117165.87	585.68	AC	446	607293.59	1117213.77	583.36	DLN
364	607277.36	1117167.36	585.75		447	607293.64	1117212.63	584.45	XDUM
365	607274.94	1117168.39	585.64	BET	448	607294.50	1117215.08	584.36	DUM
366	607274.41	1117168.62	585.62	HOR	449	607295.96	1117213.89	584.92	BET
367	607273.52	1117169.16	585.40	DLN	450	607298.36	1117212.66	584.97	
368	607279.72	1117183.82	584.82	DLN	451	607302.88	1117199.83	584.53	XAC
369	607280.87	1117183.07	585.15	HOR	452	607301.79	1117200.44	584.64	AC
370	607281.61	1117182.82	585.25	BET	453	607300.69	1117201.71	584.65	AC
371	607283.66	1117181.42	585.34		454	607299.62	1117203.66	584.78	AC
372	607286.23	1117180.13	585.28	AC	455	607298.83	1117204.74	584.88	AC
373	607286.69	1117179.95	585.20	VS	456	607298.10	1117206.04	584.89	AC
374	607287.58	1117179.64	584.87	SS	457	607305.27	1117219.92	584.94	AC
375	607291.58	1117188.27	584.60	SS	458	607303.88	1117211.38	584.27	XDUM XBZD
376	607290.45	1117188.43	585.01	VS	459	607304.02	1117211.53	584.30	DUM
377	607290.04	1117188.49	585.05	AC	460	607302.75	1117212.41	584.78	DUM
378	607291.76	1117192.29	584.97	AC	461	607302.88	1117211.89	584.63	BZD
379	607293.13	1117193.88	584.89	AC	462	607302.05	1117210.15	584.66	BZD
380	607292.52	1117192.16	584.89	VS	463	607303.13	1117209.17	584.35	BZD
381	607293.38	1117193.27	584.75	VS	464	607302.80	1117208.85	584.31	BZD
382	607292.60	1117190.56	584.72	ZNACKA	465	607301.82	1117209.65	584.72	BZD
383	607293.22	1117190.28	584.62	SS	466	607301.18	1117204.25	584.55	XVS
384	607295.14	1117192.50	584.48	SS	467	607300.80	1117206.71	584.66	VS
385	607297.57	1117193.32	584.36	SS	468	607301.52	1117209.11	584.67	VS
386	607294.63	1117193.39	584.63	VS	469	607302.59	1117211.11	583.44	NIVZN
387	607296.25	1117194.14	584.59	VS	470	607303.95	1117214.41	584.69	
388	607294.79	1117194.82	584.82	AC	471	607308.09	1117221.64	584.66	
389	607296.59	1117194.96	584.72	AC	472	607303.77	1117223.39	585.11	
390	607299.64	1117195.15	584.57	AC	473	607301.47	1117224.23	585.07	BET
391	607299.78	1117198.25	584.69		474	607300.25	1117224.23	584.88	HOR
392	607297.07	1117203.61	584.94		475	607294.18	1117216.18	584.08	XDLN
393	607294.36	1117197.83	584.93		476	607297.47	1117222.11	584.43	DLN
394	607294.80	1117204.78	585.02		477	607300.02	1117226.12	584.57	DLN
395	607291.75	1117198.61	585.04		478	607306.03	1117236.77	584.79	DLN
396	607288.15	1117191.76	585.16		479	607309.12	1117241.19	585.02	DLN
397	607285.70	1117186.27	585.26		480	607306.44	1117236.19	584.97	HOR
398	607283.85	1117187.92	585.16	BET	481	607307.71	1117235.20	585.14	BET
399	607284.11	1117189.57	585.17	BET	482	607310.01	1117233.92	585.19	
400	607283.76	1117191.37	585.16	BET	483	607312.58	1117232.55	585.04	AC
401	607283.14	1117193.09	585.14	BET	484	607313.81	1117232.26	584.83	XVS
402	607282.19	1117194.39	585.10	BET	485	607314.58	1117231.58	584.44	
403	607280.52	1117195.36	585.11	BET	486	607324.43	1117249.06	585.19	VS
404	607279.95	1117193.66	585.16	XDUM XBZD	487	607323.56	1117249.70	585.41	AC
405	607279.95	1117193.37	585.18	DUM	488	607321.49	1117251.23	585.45	
406	607281.27	1117193.33	585.16	DUM	489	607318.90	1117252.74	585.42	BET
407	607282.45	1117192.74	585.16	DUM	490	607313.82	1117246.48	585.26	HOR DLN
408	607283.27	1117189.17	585.15	DUM	491	607318.23	1117253.19	585.44	DLN
409	607283.52	1117189.26	585.21	DUM	492	607317.56	1117253.73	585.94	
410	607282.66	1117193.02	585.17	DUM	493	607323.81	1117265.32	586.57	
411	607281.30	1117193.59	585.17	DUM BZD	494	607325.26	1117264.98	585.82	DLN
412	607283.13	1117188.56	585.01	HOR	495	607325.74	1117264.66	585.71	BET
413	607281.56	1117188.87	584.52	DLN	496	607328.00	1117262.97	585.86	
414	607281.80	1117191.54	584.28	DLN	497	607330.38	1117261.44	585.94	AC
415	607281.85	1117193.00	584.08	DLN XKKAN DN90	498	607331.11	1117260.88	585.84	VS

č.bodu	Y	X	Z	popis	č.bodu	Y	X	Z	popis
499	607336.32	1117271.20	586.72	VS	582	607337.71	1117493.03	597.77	
500	607335.87	1117271.32	586.71	AC	583	607339.90	1117493.65	597.95	BET
501	607333.54	1117272.50	586.47		584	607342.77	1117493.97	598.01	
502	607330.55	1117273.65	586.19	BET	585	607345.79	1117494.09	598.01	AC
503	607330.01	1117273.97	586.22	DLN	586	607346.23	1117494.20	597.91	VS
504	607328.64	1117274.92	586.82		587	607347.03	1117494.39	597.70	SS
505	607333.05	1117283.87	587.32		588	607346.04	1117509.82	597.91	SS
506	607334.33	1117283.81	587.03	DLN	589	607345.30	1117509.67	598.14	VS
507	607334.81	1117283.80	587.04	BET	590	607344.85	1117509.69	598.20	AC
508	607337.58	1117282.86	587.32		591	607342.06	1117509.59	598.18	
509	607340.43	1117282.45	587.57	AC	592	607339.10	1117509.35	598.06	BET
510	607344.12	1117295.29	588.65	AC	593	607336.71	1117508.98	597.82	
511	607345.13	1117295.32	588.59	VS	594	607334.53	1117531.24	597.77	
512	607346.07	1117295.23	588.31	XSS	595	607336.13	1117531.13	597.92	
513	607341.46	1117296.42	588.53		596	607337.00	1117531.25	598.07	BET
514	607338.41	1117297.36	588.29	BET	597	607339.92	1117531.53	598.19	
515	607337.76	1117297.57	588.30	DLN	598	607342.82	1117531.64	598.24	AC
516	607336.59	1117298.43	588.64		599	607343.44	1117531.69	598.13	VS
517	607338.87	1117308.88	589.26	DLN	600	607344.42	1117531.79	597.87	SS
518	607339.26	1117308.90	589.39	XHOR	601	607342.70	1117546.64	597.82	SS
519	607340.32	1117309.05	589.45	BET	602	607341.49	1117546.17	598.09	VS
520	607343.14	1117308.73	589.62		603	607340.93	1117546.02	598.21	AC
521	607346.16	1117308.61	589.78	AC	604	607338.31	1117545.74	598.21	
522	607347.60	1117308.88	589.78	VS	605	607335.28	1117545.10	598.08	BET
523	607348.68	1117309.11	589.42	SS	606	607334.82	1117545.03	598.04	XHOR
524	607349.48	1117321.94	590.33	SS	607	607334.06	1117544.83	597.91	XDLN
525	607348.42	1117321.99	590.92	VS	608	607331.48	1117559.96	597.89	DLN
526	607347.11	1117322.45	590.99	AC	609	607332.85	1117559.76	598.12	BET
527	607344.11	1117322.81	590.93		610	607335.64	1117560.13	598.18	
528	607341.12	1117323.13	590.83	BET	611	607338.55	1117560.39	598.16	AC
529	607340.17	1117323.46	590.78	HOR	612	607338.93	1117560.46	598.08	VS
530	607339.51	1117323.55	590.56	DLN	613	607339.69	1117560.55	597.83	SS
531	607340.28	1117340.24	592.14	DLN	614	607336.89	1117574.08	597.82	SS
532	607340.84	1117340.54	592.32	HOR	615	607338.91	1117574.38	598.34	SBET XVV
533	607341.73	1117340.67	592.39	BET	616	607336.12	1117574.04	598.03	VS
534	607344.61	1117340.73	592.44		617	607335.81	1117574.01	598.08	AC
535	607347.69	1117340.95	592.43	AC	618	607333.00	1117573.61	598.07	
536	607348.63	1117341.29	592.33	VS	619	607330.18	1117573.50	598.00	BET
537	607349.33	1117341.35	592.12	SS	620	607329.79	1117573.38	597.93	XHOR
538	607348.27	1117349.43	592.89	SS VS	621	607328.89	1117573.55	597.69	DLN
539	607347.78	1117349.48	592.92	AC	622	607324.48	1117593.74	597.57	DLN
540	607344.68	1117349.95	593.00		623	607325.24	1117594.15	597.62	HOR
541	607341.82	1117350.16	592.97	BET	624	607325.70	1117594.44	597.68	BET
542	607341.27	1117350.25	592.93	HOR	625	607328.46	1117595.35	597.75	
543	607340.71	1117350.55	592.88	DLN	626	607331.12	1117596.01	597.65	AC
544	607341.19	1117373.08	594.10	DLN	627	607331.47	1117596.13	597.57	VS
545	607341.70	1117373.14	594.16	HOR	628	607331.97	1117596.24	597.43	SS
546	607342.06	1117373.22	594.22	BET	629	607327.45	1117616.39	597.21	SS
547	607344.90	1117373.73	594.25		630	607326.87	1117616.35	597.33	VS
548	607348.01	1117374.09	594.17	AC	631	607326.55	1117616.30	597.35	AC
549	607349.97	1117374.40	594.00		632	607323.85	1117616.05	597.38	
550	607349.46	1117390.90	594.66	XSS	633	607320.82	1117615.74	597.25	BET
551	607348.61	1117390.92	594.88	XVS	634	607320.39	1117615.73	597.21	HOR
552	607348.12	1117391.04	594.95	AC	635	607319.64	1117615.75	597.14	DLN
553	607345.16	1117391.44	595.06		636	607313.89	1117637.34	596.66	XHH
554	607342.24	1117391.64	595.05	BET	637	607315.04	1117637.78	596.68	
555	607341.85	1117391.65	595.01	HOR	638	607316.05	1117637.95	596.79	BET
556	607341.36	1117391.75	595.00	DLN	639	607318.60	1117638.28	596.92	
557	607341.67	1117410.61	595.68	DLN HOR	640	607321.79	1117638.82	596.87	AC
558	607340.28	1117410.86	595.98		641	607322.03	1117638.93	596.82	VS
559	607345.25	1117410.60	595.71		642	607322.46	1117639.03	596.80	SS
560	607342.49	1117410.82	595.67	BET	643	607318.74	1117657.31	596.45	SS
561	607348.31	1117410.93	595.66	AC	644	607318.42	1117657.14	596.55	VS
562	607348.75	1117411.01	595.59	VS	645	607318.25	1117657.01	596.57	AC
563	607349.43	1117411.00	595.45	SS	646	607315.62	1117656.62	596.64	
564	607349.32	1117432.48	596.21	SS	647	607312.52	1117655.87	596.52	BET
565	607348.60	1117432.51	596.36	VS	648	607311.37	1117655.70	596.38	
566	607348.15	1117432.53	596.41	AC	649	607310.27	1117655.70	596.43	HH
567	607345.68	1117432.75	596.45		650	607306.62	1117679.85	596.07	HH
568	607342.30	1117432.74	596.41	BET	651	607306.55	1117680.76	596.09	
569	607340.46	1117432.10	596.70		652	607307.61	1117680.70	596.04	BET
570	607339.69	1117452.49	597.18		653	607310.40	1117681.02	596.17	
571	607341.87	1117452.84	597.09	BET	654	607313.22	1117682.10	596.14	AC
572	607344.34	1117452.95	597.09		655	607313.37	1117682.03	596.12	VS
573	607347.46	1117453.01	597.08	AC	656	607314.05	1117682.06	596.07	SS
574	607348.14	1117453.03	597.08	VS	657	607311.46	1117697.21	595.52	SS
575	607348.73	1117453.14	596.93	SS	658	607310.85	1117697.08	595.74	VS
576	607347.45	1117474.45	597.57	SS	659	607310.47	1117696.99	595.81	AC
577	607347.04	1117474.62	597.71	VS	660	607307.59	1117696.63	595.82	
578	607346.68	1117474.72	597.73	AC	661	607304.57	1117696.04	595.69	BET
579	607343.97	1117474.73	597.73		662	607303.45	1117695.84	595.91	XHOR
580	607340.91	1117474.52	597.66	BET	663	607302.25	1117695.61	595.89	HH
581	607338.62	1117474.58	597.60		664	607297.59	1117714.67	595.44	HH

č.bodu	Y	X	Z	popis	č.bodu	Y	X	Z	popis
665	607298.89	1117714.86	595.55	HOR	748	607115.86	1118853.06	561.21	BET
666	607300.23	1117715.25	595.30	BET	749	607115.51	1118854.76	561.13	BET
667	607303.23	1117715.97	595.39		750	607115.56	1118854.77	561.13	BET
668	607306.09	1117716.57	595.41	AC	751	607114.89	1118851.38	561.38	XCES
669	607306.37	1117716.76	595.34	VS	752	607116.00	1118851.58	561.36	CES
670	607306.99	1117716.90	595.10	SS	753	607115.71	1118853.03	561.35	CES
671	607303.24	1117732.08	594.81	SS	754	607114.61	1118852.78	561.38	CES
672	607302.30	1117731.78	595.05	VS	755	607122.89	1118847.14	561.61	AC
673	607302.01	1117731.62	595.08	AC	756	607124.26	1118847.41	561.95	ZNACKA
674	607299.16	1117730.92	595.04		757	607122.23	1118850.98	561.41	AC
675	607296.15	1117730.09	594.94	BET	758	607122.78	1118852.16	561.35	AC
676	607295.29	1117729.98	595.12	HOR	759	607123.49	1118852.69	561.33	AC
677	607293.44	1117729.58	595.15	HH	760	607123.88	1118852.80	561.35	AC
678	607287.69	1117747.31	594.63	HH	761	607123.97	1118852.71	561.47	XAC1
679	607289.25	1117748.18	594.63		762	607124.82	1118853.38	561.73	AC1
680	607290.62	1117748.56	594.63	BET	763	607124.77	1118853.49	561.60	AC
681	607293.25	1117749.23	594.71		764	607126.18	1118854.04	561.78	AC
682	607296.44	1117749.88	594.70	AC	765	607126.15	1118853.93	561.91	AC1
683	607296.84	1117749.98	594.66	VS	766	607121.91	1118854.18	561.27	HYDRANT
684	607297.42	1117750.28	594.49	SS	767	607126.43	1118858.81	561.87	XAC
685	607291.98	1117766.73	594.11	SS	768	607126.40	1118858.96	561.94	XAC1
686	607291.53	1117766.36	594.28	VS	769	607125.46	1118858.86	561.71	AC1
687	607291.06	1117766.22	594.32	AC	770	607125.50	1118858.77	561.70	AC
688	607288.63	1117765.59	594.33		771	607123.64	1118858.91	561.41	AC
689	607288.61	1117765.58	594.33		772	607123.62	1118859.01	561.50	AC1
690	607285.66	1117764.46	594.27	BET	773	607122.65	1118859.35	561.39	AC1
691	607283.85	1117763.89	594.28		774	607122.55	1118859.21	561.25	AC
692	607281.63	1117763.20	594.41	HH	775	607121.64	1118859.82	561.16	AC
693	607279.47	1117776.01	594.23		776	607121.74	1118859.93	561.31	AC1
694	607281.54	1117776.63	593.97	BET	777	607121.32	1118860.67	561.19	AC1
695	607284.23	1117777.17	594.02		778	607121.19	1118860.59	561.12	AC
696	607287.08	1117777.96	593.98	AC	779	607121.95	1118860.64	561.48	SLIST
697	607287.42	1117778.08	593.96	VS	780	607119.30	1118866.70	560.84	AC
698	607287.61	1117778.53	593.89	SS	781	607120.59	1118866.46	560.91	ZNACKA
699	607284.36	1117787.22	593.74	SS	782	607119.79	1118870.69	560.95	SLIST
700	607284.13	1117787.08	593.78	VS	783	607118.36	1118871.85	560.67	AC
701	607283.84	1117786.95	593.80	AC	784	607115.80	1118867.23	560.83	
702	607281.55	1117785.79	593.82		785	607117.75	1118857.21	561.16	
703	607280.10	1117780.68	593.86	BET	786	607119.58	1118848.58	561.52	
704	607131.62	1118815.34	562.97	XVS1	787	607114.46	1118860.48	560.96	BET
705	607129.92	1118823.03	562.65	VS1	788	607113.73	1118860.41	560.76	ORI
706	607129.00	1118822.99	562.32	XSS	789	607112.96	1118860.35	561.03	
707	607128.60	1118822.80	562.54	XVS	790	607110.93	1118869.36	560.86	
708	607128.28	1118822.68	562.58	XAC	791	607111.53	1118871.38	560.46	ORI
709	607125.68	1118822.28	562.59		792	607111.18	1118873.83	560.39	ORI
710	607122.86	1118821.94	562.53	XBET	793	607111.90	1118870.76	560.59	BET
711	607122.33	1118821.75	562.49	XHOR	794	607111.81	1118871.57	560.52	BET
712	607121.74	1118821.50	562.34	XDLN	795	607111.90	1118871.76	560.55	BET
713	607119.47	1118831.47	561.90	DLN	796	607111.56	1118873.86	560.46	BET
714	607120.18	1118831.64	562.08	HOR	797	607111.34	1118874.28	560.42	BET
715	607120.51	1118831.89	562.15	BET	798	607110.63	1118873.55	560.63	XCES
716	607123.19	1118832.51	562.23		799	607111.44	1118873.73	560.63	CES
717	607125.72	1118833.46	562.20	AC	800	607111.81	1118871.78	560.63	CES
718	607126.21	1118833.52	562.15	VS	801	607111.05	1118871.65	560.64	CES
719	607126.88	1118833.81	561.90	SS	802	607117.37	1118876.71	560.50	AC
720	607127.63	1118834.11	562.21	VS1	803	607119.46	1118876.97	560.63	
721	607126.31	1118840.56	562.21	VS1	804	607119.07	1118878.38	560.56	
722	607125.39	1118840.71	562.13	VS1	805	607118.28	1118878.74	560.77	
723	607125.05	1118840.31	562.04	VS1	806	607117.60	1118878.97	560.62	
724	607124.70	1118839.31	561.94	VS1 VS	807	607117.84	1118879.91	560.79	SLIST
725	607125.71	1118838.83	561.43	SS	808	607116.86	1118878.95	560.46	AC
726	607125.53	1118839.58	561.34	SS VPUS	809	607115.87	1118882.72	560.23	AC
727	607124.33	1118839.69	561.94	AC	810	607113.13	1118881.87	560.26	
728	607121.92	1118839.28	561.97		811	607114.00	1118875.65	560.54	
729	607119.52	1118837.35	561.91	BET	812	607109.83	1118881.11	560.12	BET
730	607119.19	1118838.17	561.88	BET	813	607109.53	1118881.07	560.06	ORI
731	607118.30	1118838.66	561.85	BET	814	607108.69	1118880.59	560.36	
732	607117.28	1118838.75	561.98	BET	815	607107.79	1118878.82	561.13	SBET
733	607115.69	1118838.60	562.18	BET	816	607082.38	1119119.48	551.86	XAC2
734	607119.27	1118836.68	561.85	HOR	817	607082.24	1119119.72	551.85	XAC
735	607118.53	1118836.95	561.48	DLN	818	607082.11	1119119.81	551.99	XAC1
736	607118.32	1118837.67	561.50	DLN VPUS	819	607079.17	1119116.96	551.94	AC1
737	607115.22	1118842.60	562.01	XBET	820	607079.23	1119116.82	551.78	AC
738	607115.23	1118842.62	562.01	XBET	821	607079.36	1119116.60	551.77	AC2
739	607116.06	1118843.35	561.82	BET	822	607077.06	1119114.50	551.69	AC2
740	607116.67	1118843.87	561.68	BET	823	607076.91	1119114.69	551.70	AC
741	607117.34	1118844.80	561.58	BET	824	607076.74	1119114.76	551.85	AC1
742	607117.43	1118846.32	561.53	BET	825	607075.41	1119113.88	551.73	ZN
743	607116.64	1118846.53	561.37	XDLN	826	607074.73	1119112.57	551.62	AC2
744	607115.55	1118851.40	561.03	DLN XKKAN	827	607074.57	1119112.80	551.59	AC AC2
745	607115.21	1118852.98	560.96	KKAN XORI	828	607074.47	1119112.90	551.76	AC1
746	607116.08	1118851.59	561.25	BET	829	607072.96	1119111.75	551.67	AC1
747	607115.73	1118853.01	561.21	BET	830	607073.07	1119111.67	551.52	AC

č.bodu	Y	X	Z	popis	č.bodu	Y	X	Z	popis
831	607071.27	1119110.45	551.42	AC	914	607068.40	1119097.72	551.25	AC1
832	607071.19	1119110.58	551.50	AC1	915	607068.86	1119094.28	551.21	AC1
833	607071.74	1119110.01	551.40	SOUPAK	916	607068.98	1119093.27	551.31	AC1
834	607071.24	1119109.70	551.34	SOUPAK	917	607069.12	1119093.29	551.23	AC
835	607068.44	1119107.09	551.08	SOUPAK	918	607070.09	1119086.24	551.33	AC
836	607070.06	1119109.80	551.22	AC	919	607069.96	1119086.17	551.46	AC1
837	607070.01	1119109.93	551.27	AC1	920	607071.50	1119075.03	551.72	AC1
838	607068.96	1119109.58	551.08	AC1	921	607071.62	1119075.02	551.60	AC
839	607069.07	1119109.42	551.04	AC	922	607071.74	1119074.01	551.62	AC
840	607067.87	1119109.31	550.78	AC	923	607071.60	1119074.01	551.68	AC1
841	607067.35	1119108.97	550.78	AC	924	607071.52	1119073.38	551.70	AC1
842	607066.78	1119109.69	550.62	AC XCES	925	607071.71	1119073.53	551.64	AC XAC2
843	607065.72	1119110.93	550.64	AC	926	607071.81	1119073.04	551.63	AC2
844	607065.23	1119111.02	550.58	AC	927	607071.63	1119072.62	551.72	AC2
845	607065.22	1119111.01	550.63	AC	928	607071.44	1119072.82	551.73	AC
846	607067.35	1119110.16	550.69	CES	929	607071.31	1119072.88	551.79	AC1
847	607067.48	1119110.17	550.67	CES	930	607070.80	1119072.07	551.85	AC1
848	607067.36	1119109.67	550.56	VPUST	931	607070.93	1119071.96	551.81	AC
849	607067.56	1119110.06	550.62	XORI	932	607071.10	1119071.80	551.78	AC2
850	607070.33	1119112.29	550.91	ORI	933	607070.61	1119071.23	551.86	AC2
851	607070.28	1119112.45	550.93	CES	934	607070.41	1119071.45	551.85	AC
852	607074.28	1119115.67	551.10	CES	935	607070.35	1119071.55	551.90	AC1
853	607074.36	1119115.60	551.02	ORI	936	607069.67	1119071.03	551.94	AC1
854	607062.09	1119111.15	550.25	PSOUPAK	937	607069.68	1119071.03	551.95	AC1
855	607060.96	1119109.11	550.36	XAC	938	607069.73	1119070.85	551.91	AC
856	607060.74	1119108.97	550.41	XAC1	939	607069.83	1119070.61	551.91	AC2
857	607060.96	1119108.31	550.45	AC1	940	607072.10	1119068.34	551.78	
858	607061.11	1119108.35	550.41	AC	941	607072.47	1119069.44	551.74	SOUPAK
859	607061.19	1119107.68	550.42	AC	942	607074.87	1119074.49	551.64	
860	607061.06	1119107.66	550.50	AC1	943	607074.57	1119080.85	551.45	
861	607060.94	1119106.99	550.52	AC1	944	607072.21	1119079.98	551.41	SOUPAK
862	607061.08	1119106.94	550.48	AC	945	607072.15	1119077.17	551.49	SOUPAK
863	607060.77	1119106.35	550.48	AC	946	607070.86	1119083.03	551.33	VPUST
864	607060.64	1119106.42	550.55	AC1	947	607070.70	1119089.60	551.30	VPUST
865	607060.21	1119105.92	550.55	AC1	948	607069.68	1119090.13	551.23	XORI1
866	607060.31	1119105.80	550.52	AC	949	607069.82	1119089.11	551.23	ORI1
867	607059.74	1119105.40	550.51	AC	950	607077.24	1119082.15	551.38	SKRUH
868	607059.67	1119105.52	550.58	AC1	951	607077.26	1119087.27	551.24	VPUST
869	607058.53	1119104.95	550.53	AC1	952	607079.67	1119085.49	551.48	ZNACKA
870	607058.65	1119104.86	550.47	AC	953	607082.11	1119085.23	551.45	XAC
871	607059.92	1119102.25	550.51		954	607082.09	1119085.39	551.59	XAC1
872	607064.69	1119103.48	550.88		955	607079.54	1119085.52	551.47	AC1
873	607063.81	1119105.91	550.68		956	607079.51	1119085.34	551.36	AC
874	607066.47	1119107.08	550.87		957	607078.72	1119085.54	551.38	AC
875	607067.61	1119107.21	550.99		958	607078.74	1119085.68	551.48	AC1
876	607073.21	1119107.56	551.47		959	607078.24	1119086.14	551.44	AC1
877	607072.30	1119105.04	551.42		960	607078.13	1119086.09	551.28	AC
878	607071.04	1119101.05	551.36		961	607077.74	1119086.79	551.28	AC
879	607067.21	1119096.42	551.10	SKRUH	962	607077.84	1119086.79	551.39	AC1
880	607066.34	1119104.64	550.95	SKRUH	963	607077.72	1119086.84	551.28	AC XAC2
881	607061.40	1119098.84	550.62	XAC	964	607077.49	1119086.87	551.31	AC2
882	607061.46	1119098.72	550.65	XAC1 XCES	965	607077.56	1119087.87	551.29	AC2
883	607062.38	1119099.17	550.80	AC1	966	607077.78	1119087.89	551.30	AC
884	607062.35	1119099.30	550.67	AC	967	607077.90	1119087.87	551.43	AC1
885	607063.24	1119099.67	550.73	AC	968	607079.14	1119095.22	551.57	AC1
886	607063.31	1119099.55	550.85	AC1	969	607079.03	1119095.20	551.40	AC
887	607064.24	1119099.85	550.92	AC1	970	607078.76	1119095.30	551.42	AC2
888	607064.22	1119099.98	550.78	AC	971	607080.11	1119102.98	551.47	AC2
889	607065.26	1119100.09	550.85	AC	972	607080.39	1119102.84	551.47	AC
890	607065.24	1119099.94	551.00	AC1	973	607080.53	1119102.84	551.61	AC1
891	607066.21	1119099.87	551.08	AC1	974	607080.70	1119103.84	551.53	AC1
892	607066.27	1119100.00	550.93	AC	975	607081.21	1119106.78	551.54	AC1
893	607067.22	1119099.63	551.03	AC	976	607081.08	1119106.84	551.59	AC
894	607067.14	1119099.52	551.17	AC1	977	607080.78	1119106.92	551.64	AC2
895	607067.74	1119099.06	551.23	AC1	978	607080.97	1119108.02	551.60	AC2
896	607067.84	1119099.15	551.13	AC	979	607081.22	1119107.89	551.61	AC
897	607068.38	1119098.27	551.18	AC	980	607081.33	1119107.86	551.78	AC1
898	607068.27	1119098.22	551.24	AC1	981	607081.67	1119109.36	551.79	AC1
899	607062.96	1119095.65	550.77	CES	982	607081.59	1119109.37	551.59	AC
900	607063.92	1119095.99	550.91	CES	983	607081.33	1119109.46	551.59	AC2
901	607066.55	1119097.14	551.04	CES	984	607081.78	1119110.31	551.58	AC2
902	607068.33	1119097.99	551.21	CES AC1	985	607082.32	1119111.02	551.61	AC2
903	607067.00	1119093.77	551.10	XCES XFIE	986	607082.19	1119110.25	551.74	AC1
904	607065.29	1119093.08	550.96	CES	987	607082.62	1119110.78	551.77	AC1
905	607064.29	1119092.65	550.81	CES	988	607082.03	1119110.23	551.61	AC
906	607064.70	1119091.73	550.94	CES	989	607082.59	1119110.86	551.57	AC
907	607065.12	1119090.83	551.01	CES	990	607085.99	1119114.16	551.68	AC
908	607067.51	1119090.05	551.26	CES	991	607085.98	1119114.17	551.68	AC
909	607067.10	1119093.00	551.22	CES FIE	992	607085.79	1119114.32	551.65	AC2
910	607065.27	1119097.93	551.00	LLAMPA	993	607085.97	1119113.94	551.82	AC
911	607064.95	1119099.09	550.97	ZNACKA	994	607084.02	1119113.80	551.65	SOUPAK
912	607066.42	1119098.59	551.07	REK	995	607083.96	1119116.57	551.76	
913	607068.54	1119097.75	551.21	AC	996	607079.63	1119112.69	551.66	

č.bodu	Y	X	Z	popis	č.bodu	Y	X	Z	popis
997	607077.12	1119108.44	551.57		1080	607085.47	1118978.97	553.04	AC1
998	607075.60	1119102.85	551.47		1081	607085.39	1118978.84	552.99	AC
999	607079.07	1119102.70	551.46	VPUST	1082	607085.86	1118978.63	553.02	AC
1000	607074.95	1119094.11	551.41		1083	607085.93	1118978.77	553.06	AC1
1001	607077.43	1119080.93	551.42		1084	607086.32	1118978.58	553.10	AC1
1002	607082.34	1119077.92	551.54	XAC	1085	607086.38	1118978.52	553.08	AC
1003	607082.36	1119077.83	551.69	XAC1	1086	607086.90	1118978.53	553.12	AC
1004	607079.36	1119076.06	551.63	AC1	1087	607086.89	1118978.69	553.17	AC1
1005	607079.32	1119076.15	551.54	AC	1088	607087.38	1118978.78	553.27	AC1
1006	607078.71	1119075.65	551.55	AC	1089	607087.42	1118978.66	553.18	AC
1007	607078.79	1119075.51	551.64	AC1	1090	607091.25	1118979.40	553.44	AC
1008	607078.39	1119074.92	551.66	AC1	1091	607091.26	1118979.56	553.57	AC1
1009	607078.27	1119075.02	551.56	AC	1092	607088.60	1118976.79	553.31	SKRUH
1010	607078.02	1119074.53	551.66	AC	1093	607088.03	1118974.11	553.29	SOUPAK
1011	607077.95	1119074.00	551.66	AC	1094	607088.03	1118974.11	553.28	SOUPAK
1012	607078.16	1119074.51	551.74	AC1	1095	607089.46	1118970.70	553.46	SOUPAK
1013	607078.14	1119073.98	551.76	AC1	1096	607086.60	1118969.34	553.57	
1014	607078.80	1119064.01	552.13	AC1	1097	607083.89	1118974.62	553.18	
1015	607078.66	1119064.01	552.02	AC	1098	607082.38	1118978.18	553.04	
1016	607078.36	1119064.33	552.01	VPUST	1099	607084.79	1118978.92	552.89	VPUST
1017	607079.62	1119064.28	552.25	ZNACKA	1100	607080.16	1118982.71	552.93	
1018	607078.77	1119057.37	552.37	AC	1101	607077.29	1118981.85	552.86	
1019	607078.90	1119057.50	552.48	AC1	1102	607075.88	1118985.13	552.82	
1020	607079.41	1119057.72	552.52	SHRAN	1103	607072.73	1118986.24	552.55	XNEJ
1021	607078.87	1119052.01	552.59	AC	1104	607073.78	1118986.09	552.68	NEJ
1022	607079.00	1119052.01	552.73	AC1	1105	607074.14	1118987.90	552.64	NEJ
1023	607078.92	1119047.02	552.90	AC1	1106	607074.51	1118989.77	552.73	NEJ
1024	607078.79	1119046.98	552.83	AC	1107	607074.13	1118994.04	552.71	NEJ
1025	607078.88	1119046.00	552.91	AC1	1108	607073.43	1119000.48	552.60	NEJ
1026	607078.85	1119044.04	552.96	AC1	1109	607072.70	1118993.09	552.59	ZNACKA
1027	607078.83	1119043.03	553.02	AC1	1110	607073.09	1118989.21	552.35	XORI1
1028	607078.72	1119042.99	552.87	AC	1111	607073.17	1118987.20	552.35	ORI1
1029	607078.61	1119034.98	552.92	AC	1112	607073.14	1118986.83	552.37	VPUST
1030	607078.21	1119034.07	552.92	VPUST	1113	607073.25	1118986.06	552.63	SOUPAK
1031	607078.72	1119035.02	553.06	AC1	1114	607073.66	1118985.20	552.67	SOUPAK
1032	607078.69	1119034.02	552.97	AC1	1115	607074.06	1118980.34	552.75	SKRUH
1033	607078.67	1119031.03	552.95	AC1	1116	607075.62	1118978.58	552.77	VPUST
1034	607078.68	1119029.99	553.02	AC1	1117	607076.26	1118978.40	552.76	VPUST
1035	607078.52	1119030.00	552.90	AC	1118	607079.02	1118985.07	552.92	
1036	607078.50	1119025.68	552.85	AC	1119	607077.86	1118989.41	552.86	
1037	607078.62	1119025.57	553.00	AC1	1120	607076.47	1118996.98	552.80	
1038	607078.54	1119020.49	552.77	AC	1121	607076.10	1119002.03	552.80	
1039	607078.20	1119019.99	552.74	VPUST	1122	607073.86	1119001.56	552.68	SOUPAK
1040	607078.67	1119020.48	552.97	AC1	1123	607072.76	1119006.25	552.61	SOUPAK
1041	607078.69	1119019.49	552.85	AC1	1124	607075.45	1119010.69	552.80	
1042	607078.82	1119016.50	552.83	AC1	1125	607075.30	1119016.16	552.83	
1043	607078.89	1119015.50	552.90	AC1	1126	607075.18	1119020.37	552.84	
1044	607078.74	1119015.45	552.78	AC	1127	607075.07	1119025.89	552.90	
1045	607079.00	1119010.87	552.79	AC	1128	607074.97	1119030.57	552.94	
1046	607079.12	1119010.85	552.86	AC1	1129	607075.29	1119034.46	552.95	
1047	607079.39	1119005.87	552.90	AC1	1130	607072.79	1119034.69	552.86	SOUPAK
1048	607079.27	1119005.87	552.81	AC	1131	607072.92	1119032.27	552.79	SOUPAK
1049	607079.52	1119002.48	552.77	AC	1132	607073.09	1119045.40	552.72	SOUPAK
1050	607079.18	1119003.20	552.75	VPUST	1133	607075.25	1119043.04	552.90	
1051	607079.23	1119002.41	552.75	XORI1	1134	607075.51	1119047.15	552.77	
1052	607079.66	1118997.38	552.74	XORI1	1135	607075.64	1119052.54	552.58	
1053	607081.25	1118996.35	552.96	ZNACKA	1136	607075.65	1119057.68	552.34	
1054	607079.68	1119002.49	552.87	AC1	1137	607075.43	1119064.03	552.08	
1055	607079.70	1119001.52	552.87	AC1	1138	607075.09	1119069.02	551.83	
1056	607079.80	1119000.17	552.91	AC1	1139	607069.76	1119065.56	552.06	XAC
1057	607079.66	1119000.17	552.87	AC	1140	607069.88	1119065.80	552.05	XAC2
1058	607079.93	1118997.49	552.85	AC	1141	607069.70	1119065.40	552.17	XAC1
1059	607079.93	1118998.54	552.90	AC1	1142	607070.41	1119065.05	552.14	AC1
1060	607080.04	1118997.49	552.96	AC1	1143	607070.59	1119064.95	552.04	AC1
1061	607080.23	1118996.51	552.92	AC1	1144	607070.62	1119065.12	552.04	AC
1062	607080.10	1118996.47	552.79	AC	1145	607070.76	1119065.31	552.00	AC2
1063	607080.49	1118994.50	552.83	AC	1146	607071.04	1119065.13	551.98	AC2
1064	607080.62	1118994.52	552.88	AC1	1147	607071.57	1119064.55	552.01	AC2
1065	607081.46	1118990.57	552.95	AC1	1148	607071.94	1119064.14	551.98	AC2
1066	607081.34	1118990.55	552.80	AC	1149	607071.43	1119064.38	552.02	AC
1067	607082.24	1118986.72	552.89	AC	1150	607071.91	1119063.76	551.97	AC2 AC
1068	607082.38	1118986.68	552.97	AC1	1151	607071.30	1119064.28	552.04	AC1
1069	607083.56	1118985.23	553.21	ZNACKA	1152	607071.81	1119063.73	552.02	AC1
1070	607083.05	1118983.82	552.92	AC	1153	607071.79	1119062.79	552.16	AC1
1071	607083.20	1118983.82	553.04	AC1	1154	607070.84	1119060.08	552.27	ZNACKA
1072	607083.85	1118981.95	553.08	AC1	1155	607071.09	1119059.81	552.21	SBET
1073	607083.71	1118981.91	552.98	AC	1156	607071.90	1119057.38	552.23	AC
1074	607084.40	1118980.03	553.00	AC	1157	607071.75	1119057.32	552.37	AC1
1075	607084.54	1118980.08	553.11	AC1	1158	607071.71	1119051.32	552.62	AC1
1076	607084.78	1118979.65	553.02	AC1	1159	607071.87	1119051.35	552.55	AC
1077	607084.65	1118979.59	553.00	AC	1160	607071.85	1119046.83	552.70	AC
1078	607085.01	1118979.17	553.00	AC	1161	607071.73	1119046.80	552.81	AC1
1079	607085.11	1118979.23	553.03	AC1	1162	607071.71	1119042.78	552.91	AC1

č.bodu	Y	X	Z	popis	č.bodu	Y	X	Z	popis
1163	607071.83	1119042.79	552.75	AC	1246	607080.25	1118974.75	553.10	AC
1164	607071.80	1119035.73	552.84	AC	1247	607080.97	1118973.32	553.14	AC
1165	607071.69	1119035.72	552.90	AC1	1248	607080.86	1118973.27	553.21	AC1
1166	607071.69	1119034.73	552.82	AC1	1249	607081.29	1118972.35	553.35	AC1
1167	607071.69	1119032.43	552.80	AC1	1250	607081.42	1118972.40	553.23	AC
1168	607071.70	1119031.41	552.84	AC1	1251	607083.55	1118967.92	553.51	AC
1169	607071.83	1119031.40	552.76	AC	1252	607083.42	1118967.84	553.60	AC1
1170	607071.84	1119027.40	552.70	AC	1253	607085.13	1118964.25	553.83	AC1
1171	607071.72	1119027.40	552.84	AC1	1254	607085.56	1118963.34	553.79	AC1
1172	607071.73	1119026.41	552.72	AC1	1255	607085.27	1118964.27	553.69	AC
1173	607071.73	1119026.41	552.75	AC1	1256	607085.68	1118963.39	553.76	AC
1174	607071.74	1119025.06	552.75	AC1	1257	607086.50	1118961.58	553.92	AC
1175	607071.77	1119024.05	552.74	AC1	1258	607086.38	1118961.51	553.98	AC1
1176	607071.88	1119024.03	552.67	AC	1259	607086.76	1118960.61	554.06	AC1
1177	607071.88	1119020.03	552.62	AC	1260	607086.88	1118960.64	553.98	AC
1178	607071.75	1119020.03	552.71	AC1	1261	607087.05	1118960.14	554.03	AC
1179	607071.79	1119015.52	552.66	AC1	1262	607086.91	1118960.10	554.14	AC1
1180	607071.93	1119015.50	552.58	AC	1263	607087.05	1118959.12	554.23	AC1
1181	607072.08	1119009.75	552.56	AC	1264	607087.19	1118959.11	554.08	AC
1182	607071.96	1119009.70	552.70	AC1	1265	607087.01	1118958.11	554.14	AC
1183	607072.14	1119004.71	552.62	AC1	1266	607086.86	1118958.14	554.32	AC1
1184	607072.28	1119004.70	552.50	AC	1267	607086.51	1118957.24	554.41	AC1
1185	607072.38	1119001.98	552.47	AC	1268	607086.62	1118957.15	554.26	AC
1186	607072.24	1119001.97	552.61	AC1	1269	607086.12	1118956.30	554.38	AC
1187	607072.51	1118995.89	552.57	AC1	1270	607086.00	1118956.38	554.50	AC1
1188	607072.63	1118995.93	552.42	AC	1271	607085.72	1118955.94	554.56	AC1
1189	607072.66	1118992.70	552.61	AC1	1272	607085.85	1118955.87	554.41	AC
1190	607072.81	1118992.59	552.45	AC	1273	607085.22	1118955.09	554.54	AC
1191	607072.91	1118989.19	552.44	AC XNZP	1274	607085.12	1118955.19	554.57	AC1
1192	607073.34	1118989.20	552.42	NZP	1275	607084.28	1118954.39	554.68	AC1
1193	607073.43	1118987.20	552.42	NZP	1276	607084.39	1118954.28	554.64	AC
1194	607073.52	1118987.01	552.42	NZP	1277	607083.76	1118953.72	554.70	AC
1195	607073.37	1118986.47	552.42	NZP	1278	607083.05	1118953.12	554.82	AC
1196	607072.96	1118987.89	552.45	AC	1279	607083.68	1118953.83	554.76	AC1
1197	607072.85	1118987.90	552.63	AC1	1280	607082.93	1118953.22	554.96	AC1
1198	607072.79	1118987.32	552.60	AC1	1281	607083.88	1118953.68	554.69	SOUPAK
1199	607072.93	1118987.28	552.39	AC	1282	607086.37	1118957.79	554.36	HYDRANT
1200	607072.83	1118986.81	552.39	AC	1283	607081.00	1118971.09	553.37	SOUPAK
1201	607072.74	1118986.52	552.41	NZP AC	1284	607078.09	1118974.70	553.11	ZNACKA
1202	607072.63	1118986.29	552.55	AC	1285	607090.96	1118971.54	553.60	ZNACKA
1203	607072.71	1118986.90	552.59	AC1	1286	607089.45	1118970.70	553.39	SOUPAK
1204	607072.52	1118986.37	552.67	AC1	1287	607091.37	1118968.77	553.85	STUDNA
1205	607072.07	1118985.52	552.69	AC1	1288	607093.37	1118973.35	553.71	XBET1
1206	607072.19	1118985.44	552.64	AC	1289	607093.38	1118973.48	553.69	XBET
1207	607071.53	1118984.80	552.71	AC	1290	607092.01	1118973.07	553.57	BET
1208	607071.44	1118984.90	552.75	AC1	1291	607092.06	1118972.96	553.61	BET1
1209	607070.60	1118984.41	552.75	AC1	1292	607091.20	1118972.59	553.59	BET1
1210	607070.67	1118984.28	552.66	AC	1293	607091.16	1118972.66	553.50	BET
1211	607069.78	1118983.88	552.61	AC	1294	607090.33	1118971.86	553.45	BET
1212	607069.72	1118983.99	552.72	AC1	1295	607090.45	1118971.83	553.45	BET1
1213	607070.68	1118981.39	552.66		1296	607089.85	1118970.81	553.45	BET
1214	607073.03	1118976.87	552.74	SZEL	1297	607090.77	1118970.45	553.72	
1215	607074.01	1118977.08	552.85	SBET	1298	607090.56	1118969.35	553.75	
1216	607074.13	1118976.70	552.84	SBET	1299	607089.68	1118969.35	553.59	BET
1217	607074.40	1118977.86	552.93	REK	1300	607090.30	1118967.27	553.74	BET
1218	607070.81	1118978.27	552.61	XAC	1301	607091.38	1118967.76	553.87	XPZIV
1219	607070.88	1118978.16	552.66	XAC1	1302	607092.48	1118965.01	554.04	PZIV
1220	607071.81	1118978.45	552.79	AC1 XCES	1303	607092.91	1118964.88	554.09	XCES
1221	607072.82	1118978.53	552.81	AC1	1304	607091.96	1118964.47	554.02	CES
1222	607072.84	1118978.67	552.69	AC	1305	607092.38	1118963.32	554.10	CES
1223	607072.93	1118975.60	552.67	CES	1306	607093.55	1118963.77	554.13	CES
1224	607075.74	1118976.70	552.76	CES	1307	607091.92	1118963.27	554.12	BET
1225	607072.16	1118976.01	552.65	SOUPAK	1308	607089.55	1118962.21	554.12	
1226	607072.06	1118976.19	552.62	SOUPAK	1309	607087.44	1118967.14	553.73	
1227	607072.82	1118978.54	552.81	AC1	1310	607093.47	1118963.29	554.16	XPZIV
1228	607072.81	1118978.68	552.68	AC	1311	607094.80	1118959.72	554.43	PZIV
1229	607073.82	1118978.64	552.70	AC	1312	607093.69	1118959.26	554.43	BET
1230	607073.81	1118978.51	552.81	AC1	1313	607091.22	1118958.11	554.42	
1231	607074.80	1118978.32	552.84	AC1	1314	607094.93	1118958.95	554.60	ZNACKA
1232	607074.84	1118978.46	552.71	AC	1315	607095.51	1118954.85	554.74	BET XNZP
1233	607075.80	1118978.18	552.71	AC	1316	607096.59	1118955.22	554.74	NZP
1234	607075.76	1118978.06	552.89	AC1	1317	607096.80	1118955.63	554.66	PZIV
1235	607076.65	1118977.70	553.01	AC1	1318	607097.31	1118954.36	554.70	XPZIV
1236	607076.74	1118977.81	552.78	AC	1319	607095.87	1118954.01	554.79	BET XNZP
1237	607077.33	1118977.34	552.99	CES AC1	1320	607097.18	1118954.65	554.69	NZP
1238	607077.45	1118977.45	552.86	AC	1321	607093.40	1118953.05	554.81	
1239	607078.22	1118976.96	552.89	AC	1322	607095.28	1118948.07	555.23	
1240	607078.16	1118976.83	553.03	AC1	1323	607098.03	1118948.49	555.32	BET
1241	607078.90	1118976.18	553.10	AC1	1324	607098.80	1118948.23	555.23	BET
1242	607079.01	1118976.28	552.94	AC	1325	607099.13	1118948.28	555.31	BET
1243	607079.70	1118975.52	552.99	AC	1326	607100.40	1118948.56	555.25	BET
1244	607079.59	1118975.45	553.05	AC1	1327	607099.73	1118949.25	555.21	PZIV
1245	607080.13	1118974.67	553.10	AC1	1328	607101.16	1118945.86	555.25	XBET

č.bodu	Y	X	Z	popis	č.bodu	Y	X	Z	popis
1329	607100.19	1118945.36	555.38	BET	1412	607126.31	1118804.33	563.59	HOR
1330	607099.64	1118944.51	555.54	BET	1413	607126.85	1118803.67	563.43	AC
1331	607099.64	1118944.52	555.55	BET	1414	607129.46	1118803.77	563.55	
1332	607099.78	1118943.90	555.63	BET	1415	607132.27	1118803.91	563.40	BET
1333	607099.78	1118943.90	555.62	BET	1416	607132.63	1118803.93	563.35	VS
1334	607099.78	1118943.89	555.62	BET	1417	607133.05	1118804.03	563.13	SS
1335	607099.78	1118943.88	555.61	BET	1418	607135.75	1118793.18	563.67	SS
1336	607099.78	1118943.89	555.58	BET	1419	607135.22	1118792.75	563.89	VS
1337	607101.88	1118944.22	555.97	XPLO	1420	607134.90	1118792.62	563.94	BET
1338	607094.05	1118941.36	555.88	XZID	1421	607132.35	1118792.28	564.03	
1339	607094.22	1118941.57	555.74	ZID	1422	607129.52	1118791.39	563.96	AC
1340	607093.25	1118942.67	555.68	ZID	1423	607128.82	1118791.34	563.91	HOR DLN
1341	607092.99	1118943.25	555.67	ZNACKA	1424	607127.70	1118791.07	564.80	
1342	607092.20	1118943.52	555.77	ZID	1425	607129.21	1118786.27	564.68	MIST
1343	607090.71	1118944.41	555.74	ZID	1426	607137.53	1118787.70	564.00	MIST
1344	607090.49	1118945.07	555.59	SBET	1427	607138.84	1118778.35	564.49	SS
1345	607089.48	1118944.88	555.66	ZID	1428	607138.33	1118777.91	564.72	VS
1346	607088.06	1118945.19	555.59	ZID	1429	607137.93	1118777.68	564.77	BET
1347	607088.15	1118948.28	554.92	XAC	1430	607135.13	1118777.80	564.86	
1348	607088.21	1118948.20	555.06	XAC1	1431	607132.45	1118777.54	564.75	AC
1349	607089.21	1118948.27	555.08	AC1	1432	607131.57	1118777.36	564.69	DLN
1350	607089.19	1118948.39	554.91	AC	1433	607130.34	1118777.11	565.76	
1351	607090.15	1118948.43	554.88	AC	1434	607133.44	1118762.25	566.50	
1352	607090.14	1118948.30	554.98	AC1	1435	607134.87	1118762.17	565.51	DLN
1353	607091.10	1118948.21	554.97	AC1	1436	607135.36	1118762.32	565.50	AC
1354	607091.13	1118948.34	554.92	AC	1437	607138.16	1118762.87	565.58	
1355	607091.79	1118947.71	555.04	AC	1438	607140.91	1118763.34	565.51	BET
1356	607093.25	1118944.83	555.27	AC	1439	607141.29	1118763.40	565.54	VS
1357	607094.35	1118942.29	555.47	AC	1440	607142.09	1118763.63	565.12	SS
1358	607097.01	1118943.40	555.54		1441	607143.36	1118757.03	565.72	SS
1359	607099.59	1118934.35	556.17		1442	607143.17	1118755.20	566.09	SS VS
1360	607097.04	1118933.43	556.08	AC	1443	607145.04	1118748.37	566.63	SS VS
1361	607095.28	1118932.86	557.54		1444	607144.50	1118748.11	566.43	VS
1362	607102.80	1118934.89	556.25	BET	1445	607144.21	1118748.00	566.72	BET
1363	607104.58	1118935.13	557.11	PLO	1446	607141.54	1118747.39	566.37	
1364	607107.82	1118924.04	557.75	PLO	1447	607138.97	1118745.70	566.42	AC
1365	607106.24	1118923.53	557.18	BET	1448	607138.40	1118745.54	566.39	DLN
1366	607103.39	1118922.64	557.27		1449	607137.02	1118745.22	567.26	
1367	607098.78	1118921.39	558.41		1450	607140.66	1118729.99	567.96	
1368	607100.51	1118921.36	557.11	AC	1451	607141.98	1118729.78	567.13	DLN
1369	607101.27	1118913.18	558.89		1452	607142.61	1118729.77	567.20	AC
1370	607102.45	1118913.65	557.82	AC	1453	607145.23	1118730.50	567.23	
1371	607105.25	1118914.75	557.99		1454	607148.26	1118731.32	567.26	BET
1372	607108.26	1118915.75	557.93	BET	1455	607148.51	1118731.23	567.18	VS
1373	607110.29	1118916.77	558.40	PLO	1456	607149.04	1118731.42	567.04	SS
1374	607109.56	1118916.85	558.22	ZNACKA	1457	607152.69	1118715.95	567.85	SS
1375	607110.81	1118909.01	558.45	VPUST	1458	607152.18	1118715.70	567.91	VS
1376	607111.07	1118908.00	558.48	XSS	1459	607151.97	1118715.61	567.93	BET
1377	607112.22	1118907.60	558.75		1460	607149.08	1118715.09	568.02	
1378	607113.05	1118903.05	559.16		1461	607144.53	1118713.80	568.76	
1379	607112.40	1118902.98	558.91	SS	1462	607146.09	1118713.71	567.94	DLN
1380	607111.52	1118902.64	559.06	BET	1463	607146.55	1118713.81	567.97	AC
1381	607108.60	1118902.46	559.05		1464	607150.68	1118697.26	568.49	AC
1382	607103.50	1118902.07	559.74		1465	607150.08	1118696.97	568.48	DLN
1383	607104.98	1118902.44	558.86	AC	1466	607148.78	1118696.86	569.15	
1384	607104.86	1118902.37	558.91	XAC1	1467	607153.37	1118697.27	568.63	
1385	607106.31	1118897.64	559.32	AC1	1468	607156.23	1118698.27	568.59	BET
1386	607106.43	1118897.64	559.21	AC	1469	607156.56	1118698.16	568.55	VS
1387	607106.25	1118897.03	559.23	VPUST	1470	607157.04	1118698.12	568.41	SS
1388	607106.38	1118896.53	559.30	XORI	1471	607157.66	1118698.25	568.73	XVS1
1389	607108.20	1118887.51	559.80	ORI	1472	607161.55	1118684.13	569.33	VS1
1390	607108.50	1118887.50	559.91	AC	1473	607160.70	1118683.94	568.97	SS
1391	607106.46	1118887.24	560.56		1474	607160.36	1118683.56	569.00	VS
1392	607111.44	1118887.98	560.01		1475	607160.01	1118683.24	569.03	BET
1393	607114.60	1118888.66	559.88	BET	1476	607157.52	1118682.60	569.15	
1394	607115.35	1118888.78	559.92	SS	1477	607152.10	1118681.88	569.62	
1395	607116.49	1118888.77	560.16		1478	607153.87	1118681.95	568.94	DLN
1396	607130.33	1118814.51	562.95	BET XNZP	1479	607154.55	1118681.91	568.98	AC
1397	607130.94	1118814.92	562.60	XKKAN	1480	607158.14	1118668.11	569.60	AC
1398	607132.80	1118812.26	563.12	NZP	1481	607157.23	1118668.29	569.56	DLN
1399	607135.44	1118810.26	563.30	NZP	1482	607155.32	1118668.16	570.03	XPLO
1400	607136.95	1118808.31	563.52	NZP	1483	607160.93	1118669.02	569.74	
1401	607134.39	1118805.54	563.66	XNZP	1484	607163.68	1118669.40	569.79	BET
1402	607132.73	1118808.03	563.34	NZP	1485	607163.98	1118669.44	569.72	VS
1403	607131.34	1118809.01	563.21	BET NZP	1486	607164.57	1118669.67	569.60	SS
1404	607132.34	1118807.91	562.95	XSS KKAN40	1487	607165.53	1118669.75	569.87	VS1
1405	607131.96	1118807.61	563.21	XVS	1488	607168.77	1118657.46	570.46	VS1
1406	607124.93	1118813.20	563.28	XAC	1489	607167.81	1118657.16	570.10	SS
1407	607124.48	1118812.51	563.15	XHOR	1490	607167.46	1118656.76	570.20	VS
1408	607123.96	1118812.27	563.07	XDLN	1491	607167.11	1118656.64	570.22	BET
1409	607122.83	1118811.94	563.94		1492	607164.30	1118656.49	570.25	
1410	607124.54	1118804.28	564.57		1493	607161.18	1118656.04	570.09	AC
1411	607126.02	1118804.50	563.44	DLN	1494	607158.25	1118656.69	570.50	XBRA PLO

č.bodu	Y	X	Z	popis	č.bodu	Y	X	Z	popis
1495	607155.24	1118653.27	570.56	BRA	1578	607191.27	1118455.32	573.57	HOR
1496	607165.24	1118641.42	570.53	AC	1579	607192.12	1118455.29	573.39	AC
1497	607164.15	1118641.02	570.57		1580	607194.65	1118455.40	573.53	
1498	607162.58	1118640.68	570.65		1581	607200.76	1118455.83	574.18	
1499	607168.07	1118641.78	570.61		1582	607198.72	1118455.72	573.39	SS
1500	607170.86	1118642.45	570.59	BET	1583	607198.17	1118455.54	573.47	VS
1501	607171.18	1118642.41	570.55	VS	1584	607197.80	1118455.35	573.55	BET
1502	607171.64	1118642.41	570.49	SS	1585	607200.38	1118432.32	574.09	BET
1503	607172.90	1118642.48	570.97	VS1	1586	607200.91	1118431.98	574.09	VS
1504	607176.57	1118628.09	571.27	VS1	1587	607201.62	1118431.94	573.98	SS
1505	607175.46	1118627.34	570.81	SS	1588	607203.71	1118431.92	574.80	
1506	607175.08	1118627.10	570.88	VS	1589	607197.84	1118431.26	574.11	
1507	607174.75	1118626.90	570.91	BET	1590	607194.85	1118431.14	573.93	AC
1508	607172.21	1118626.39	570.94		1591	607194.35	1118431.18	574.02	HOR
1509	607169.22	1118625.80	570.87	AC	1592	607190.87	1118430.79	574.14	
1510	607168.46	1118625.77	570.93		1593	607196.84	1118408.11	574.42	HOR XDLN
1511	607166.75	1118625.50	570.92		1594	607197.45	1118408.17	574.42	AC
1512	607170.24	1118610.64	571.26		1595	607193.15	1118407.93	574.44	
1513	607171.65	1118610.48	571.20		1596	607200.39	1118408.94	574.57	
1514	607172.55	1118610.42	571.12	AC	1597	607205.75	1118410.55	575.22	
1515	607175.38	1118610.73	571.23		1598	607203.72	1118410.18	574.38	SS
1516	607178.16	1118611.12	571.21	BET	1599	607203.34	1118410.09	574.49	VS
1517	607178.45	1118611.12	571.19	VS	1600	607203.17	1118409.92	574.49	BET
1518	607179.04	1118611.10	571.02	SS	1601	607197.20	1118401.01	574.60	HOR
1519	607180.25	1118610.89	571.44	VS1	1602	607196.45	1118400.95	574.45	DLN
1520	607182.81	1118597.34	571.81	VS1	1603	607195.86	1118394.79	574.50	DLN
1521	607181.33	1118597.00	571.31	SS	1604	607196.62	1118394.32	574.72	HOR
1522	607180.84	1118596.79	571.42	VS	1605	607199.05	1118393.94	574.84	AC
1523	607180.50	1118596.66	571.46	BET	1606	607201.79	1118394.22	574.85	
1524	607178.18	1118596.54	571.48		1607	607204.97	1118394.55	574.84	BET
1525	607174.78	1118595.90	571.42		1608	607205.57	1118394.75	574.78	VS SS
1526	607173.34	1118595.78	571.40		1609	607207.22	1118394.88	575.45	
1527	607175.18	1118596.11	571.41	AC	1610	607209.01	1118382.66	575.86	
1528	607177.18	1118578.91	571.63	AC	1611	607207.24	1118382.08	575.03	SS
1529	607176.70	1118578.77	571.65		1612	607206.67	1118381.95	575.14	VS
1530	607175.74	1118579.09	571.62		1613	607206.38	1118381.90	575.16	BET
1531	607179.99	1118579.48	571.71		1614	607203.40	1118381.74	575.16	
1532	607182.75	1118579.76	571.71	BET	1615	607199.97	1118381.44	575.10	
1533	607183.01	1118579.80	571.69	VS	1616	607198.23	1118381.58	575.26	
1534	607183.55	1118579.90	571.61	SS	1617	607200.58	1118381.68	575.05	AC
1535	607185.28	1118580.23	572.14		1618	607202.43	1118366.64	575.37	AC
1536	607187.24	1118586.56	572.61	NIVZN	1619	607201.16	1118366.39	575.45	
1537	607187.14	1118565.46	572.59		1620	607198.39	1118366.24	575.39	
1538	607185.42	1118565.05	571.73	SS	1621	607205.25	1118366.54	575.51	
1539	607184.99	1118564.82	571.83	VS	1622	607208.27	1118366.94	575.43	BET
1540	607184.58	1118564.72	571.86	BET	1623	607208.97	1118367.09	575.40	SS
1541	607182.04	1118564.40	571.92		1624	607210.47	1118366.86	575.96	
1542	607178.60	1118563.83	571.88		1625	607213.02	1118352.81	576.32	
1543	607177.40	1118563.69	571.86		1626	607210.97	1118352.43	575.65	SS
1544	607179.09	1118563.76	571.88	AC	1627	607210.14	1118352.30	575.69	BET
1545	607181.61	1118541.73	572.10	AC	1628	607207.66	1118351.71	575.75	
1546	607181.16	1118541.57	572.13		1629	607204.65	1118351.00	575.67	AC XNEJ
1547	607180.34	1118541.47	572.05		1630	607202.58	1118349.63	575.47	NEJ
1548	607184.28	1118542.01	572.16		1631	607198.92	1118347.29	575.28	NEJ
1549	607187.30	1118542.26	572.18	BET	1632	607198.40	1118342.34	575.23	XNEJ
1550	607187.52	1118542.24	572.15	VS	1633	607202.80	1118342.56	575.42	NEJ
1551	607187.91	1118542.13	572.12	SS	1634	607206.02	1118341.72	575.81	NEJ AC
1552	607189.42	1118542.29	572.93		1635	607203.12	1118339.88	575.34	XVS
1553	607192.36	1118520.61	573.35		1636	607205.65	1118339.52	575.69	VS
1554	607190.64	1118520.62	572.35	SS	1637	607206.22	1118338.56	575.81	VS
1555	607190.30	1118520.45	572.44	VS	1638	607206.65	1118336.34	575.91	VS
1556	607190.00	1118520.37	572.46	BET	1639	607205.50	1118338.17	575.15	XKKAN XDLN
1557	607187.34	1118519.95	572.50		1640	607203.56	1118338.86	575.16	DLN
1558	607183.92	1118519.57	572.42		1641	607211.53	1118343.60	575.77	BET XNEJ
1559	607181.70	1118519.33	572.39		1642	607215.04	1118341.41	576.02	NEJ
1560	607184.30	1118519.18	572.40	AC	1643	607212.62	1118338.32	575.86	BET XNEJ
1561	607186.32	1118503.00	572.66	AC	1644	607216.10	1118337.45	576.04	NEJ
1562	607185.39	1118502.67	572.72	XHOR	1645	607213.50	1118336.96	575.53	KKAN XDLN
1563	607183.22	1118502.43	572.75		1646	607212.91	1118337.33	575.80	XHOR
1564	607188.87	1118503.37	572.80		1647	607216.10	1118332.00	576.23	
1565	607194.84	1118503.63	573.57		1648	607214.74	1118331.48	575.76	DLN
1566	607193.02	1118503.55	572.66	SS	1649	607214.17	1118331.35	575.88	HOR
1567	607192.43	1118503.40	572.76	VS	1650	607213.92	1118331.31	575.92	BET
1568	607192.09	1118503.37	572.78	BET	1651	607211.14	1118331.03	576.06	
1569	607194.94	1118480.22	573.11	BET	1652	607208.24	1118330.63	576.02	AC
1570	607195.35	1118479.31	573.09	VS	1653	607205.39	1118337.70	575.36	XSS
1571	607196.00	1118479.20	572.94	SS	1654	607204.44	1118337.30	575.69	
1572	607197.86	1118479.26	573.73		1655	607205.71	1118331.09	575.80	
1573	607192.31	1118478.70	573.14		1656	607206.69	1118331.28	575.66	SS
1574	607189.31	1118478.38	572.96	AC	1657	607209.56	1118317.28	575.93	SS
1575	607188.43	1118478.42	573.16	HOR	1658	607208.10	1118316.77	575.97	
1576	607185.76	1118478.24	573.19		1659	607210.60	1118318.30	576.23	VS
1577	607188.95	1118455.08	573.71		1660	607210.96	1118318.40	576.26	AC

č.bodu	Y	X	Z	popis	č.bodu	Y	X	Z	popis
1661	607213.55	1118318.56	576.28		1744	607217.14	1118186.46	579.37	
1662	607216.56	1118318.87	576.11	BET	1745	607220.11	1118185.82	579.30	BET
1663	607216.89	1118318.99	576.06	HOR	1746	607220.41	1118185.76	579.27	HOR
1664	607217.62	1118319.16	575.87	DLN	1747	607220.97	1118185.46	579.13	DLN
1665	607218.90	1118319.46	576.28		1748	607222.42	1118184.78	580.01	
1666	607222.91	1118303.85	576.34		1749	607212.66	1118164.96	580.04	
1667	607221.77	1118303.46	576.02	DLN	1750	607217.78	1118162.63	580.70	
1668	607221.03	1118302.80	576.36	HOR	1751	607216.32	1118163.05	579.67	DLN
1669	607220.38	1118303.05	576.42	BET	1752	607215.52	1118162.82	579.91	HOR
1670	607217.68	1118302.33	576.54		1753	607215.13	1118162.93	580.00	BET
1671	607214.74	1118301.76	576.49	AC	1754	607209.41	1118164.00	579.99	AC
1672	607214.34	1118301.75	576.48	VS	1755	607208.96	1118164.12	579.97	VS
1673	607213.23	1118301.64	576.09	SS	1756	607208.60	1118164.22	579.86	SS
1674	607211.94	1118301.64	576.20		1757	607207.17	1118164.48	580.18	
1675	607216.26	1118283.83	576.60		1758	607203.09	1118147.03	580.64	
1676	607217.55	1118284.48	576.37	SS	1759	607204.53	1118146.57	580.22	SS
1677	607218.38	1118284.97	576.63	VS	1760	607205.11	1118146.70	580.34	VS
1678	607218.78	1118285.12	576.70	AC	1761	607205.59	1118146.67	580.40	AC
1679	607221.94	1118285.59	576.78		1762	607208.35	1118145.75	580.49	
1680	607224.60	1118286.53	576.72	BET	1763	607211.23	1118144.89	580.41	BET
1681	607225.11	1118286.65	576.70	HOR	1764	607211.48	1118144.83	580.40	HOR
1682	607226.03	1118287.33	576.30	DLN DLN	1765	607212.03	1118144.71	580.21	DLN
1683	607227.33	1118287.15	576.69		1766	607213.35	1118144.27	581.05	
1684	607232.65	1118232.14	578.02	KRIZEK	1767	607210.68	1118130.92	581.60	
1685	607231.94	1118270.48	577.06		1768	607209.05	1118131.03	580.72	DLN
1686	607230.79	1118270.09	576.63	DLN	1769	607208.70	1118130.96	580.78	HOR
1687	607229.70	1118269.37	577.11	HOR	1770	607208.49	1118130.89	580.83	BET
1688	607228.85	1118269.08	577.20	BET	1771	607205.61	1118131.74	580.91	
1689	607225.98	1118268.40	577.17		1772	607202.75	1118132.43	580.88	AC
1690	607222.97	1118267.52	577.07	AC	1773	607202.29	1118132.54	580.83	VS
1691	607222.61	1118267.47	577.02	VS	1774	607201.51	1118132.89	580.56	SS
1692	607221.58	1118267.46	576.72	SS	1775	607200.06	1118133.21	580.91	
1693	607220.17	1118267.16	577.05		1776	607197.62	1118120.75	581.35	
1694	607222.13	1118257.10	577.42		1777	607198.95	1118120.01	581.05	SS
1695	607223.96	1118256.64	577.20	SS VS	1778	607200.10	1118119.36	581.36	VS
1696	607224.53	1118256.74	577.21	AC	1779	607200.49	1118119.25	581.41	AC
1697	607227.41	1118256.94	577.40		1780	607203.41	1118118.88	581.43	
1698	607230.76	1118257.45	577.47	BET	1781	607206.26	1118118.05	581.29	BET
1699	607232.06	1118257.29	577.37	HOR	1782	607206.54	1118118.03	581.26	HOR
1700	607233.22	1118257.46	576.97	DLN	1783	607206.89	1118117.87	581.10	DLN
1701	607234.02	1118251.43	577.07	DLN	1784	607208.26	1118117.52	581.74	
1702	607232.89	1118251.10	577.52	HOR	1785	607207.91	1118105.66	582.44	
1703	607231.08	1118251.07	577.61	BET	1786	607205.73	1118105.49	581.64	DLN
1704	607228.09	1118251.08	577.49		1787	607205.13	1118105.37	581.86	HOR
1705	607225.01	1118251.19	577.28	AC	1788	607204.92	1118105.27	581.87	BET
1706	607224.48	1118251.18	577.30	VS	1789	607202.03	1118105.94	581.93	
1707	607222.94	1118251.32	577.48		1790	607199.02	1118106.49	581.92	AC
1708	607222.16	1118244.75	577.72		1791	607198.57	1118106.48	581.89	VS
1709	607224.39	1118244.31	577.48	VS	1792	607196.96	1118106.79	581.36	SS
1710	607224.96	1118244.37	577.44	AC	1793	607195.82	1118095.31	581.78	SS
1711	607227.65	1118243.80	577.64		1794	607197.55	1118094.34	582.48	VS
1712	607230.96	1118243.70	577.75	BET	1795	607197.98	1118094.34	582.51	AC
1713	607232.30	1118244.20	577.65	HOR	1796	607200.98	1118094.26	582.52	
1714	607233.46	1118243.55	577.26	DLN	1797	607206.55	1118093.63	582.75	
1715	607231.48	1118234.55	577.69	DLN	1798	607204.87	1118093.56	582.19	DLN
1716	607230.72	1118234.48	577.89	HOR	1799	607204.30	1118093.68	582.40	HOR
1717	607230.05	1118234.62	577.96	BET	1800	607204.02	1118093.57	582.46	BET
1718	607227.50	1118234.89	577.85		1801	607203.45	1118080.61	582.96	BET
1719	607224.08	1118236.20	577.68	VS XSS	1802	607203.64	1118080.58	582.92	HOR
1720	607224.40	1118235.93	577.71	AC	1803	607204.32	1118080.50	582.68	DLN
1721	607222.27	1118236.25	577.96		1804	607206.08	1118080.32	583.63	
1722	607221.29	1118227.19	578.15		1805	607200.55	1118080.93	582.98	
1723	607222.29	1118226.66	577.95	SS	1806	607197.61	1118080.79	583.07	AC
1724	607222.65	1118226.54	578.00	VS	1807	607197.25	1118080.81	582.93	VS
1725	607223.06	1118226.54	578.04	AC	1808	607195.53	1118080.31	582.29	SS
1726	607225.71	1118225.75	578.19		1809	607195.23	1118064.77	582.83	SS
1727	607228.47	1118224.86	578.16	BET	1810	607197.41	1118063.87	583.56	VS
1728	607228.78	1118224.79	578.20	HOR	1811	607197.81	1118063.67	583.56	AC
1729	607229.67	1118224.54	577.95	DLN	1812	607200.64	1118063.49	583.57	
1730	607230.89	1118224.09	578.35		1813	607205.38	1118063.96	584.03	
1731	607226.51	1118204.47	579.29		1814	607203.99	1118063.99	583.33	DLN
1732	607225.05	1118204.46	578.51	DLN	1815	607203.47	1118064.16	583.41	BET
1733	607224.49	1118204.23	578.67	HOR	1816	607203.72	1118063.75	583.39	HOR
1734	607224.20	1118204.26	578.72	BET	1817	607204.08	1118055.82	583.70	HOR
1735	607221.52	1118205.11	578.79		1818	607204.60	1118055.72	583.56	DLN
1736	607218.53	1118205.79	578.69	AC	1819	607203.95	1118055.43	583.66	BET
1737	607218.07	1118205.85	578.66	VS	1820	607205.90	1118055.62	584.43	
1738	607217.52	1118205.95	578.47	SS	1821	607201.31	1118054.95	583.77	
1739	607215.76	1118206.29	578.72		1822	607198.28	1118054.85	583.79	AC
1740	607211.86	1118188.18	579.31		1823	607197.75	1118054.70	583.79	VS
1741	607213.26	1118187.80	579.03	SS	1824	607196.21	1118054.98	583.35	SS
1742	607214.06	1118187.44	579.29	VS	1825	607197.83	1118042.67	583.93	SS
1743	607214.36	1118187.10	579.30	AC	1826	607198.87	1118042.35	584.21	VS

č.bodu	Y	X	Z	popis	č.bodu	Y	X	Z	popis
1827	607199.46	1118042.13	584.42	AC	1910	607230.54	1117906.85	590.62	
1828	607202.33	1118042.36	584.37		1911	607232.07	1117907.50	590.01	SS
1829	607205.33	1118042.10	584.14	BET	1912	607232.37	1117907.62	590.08	VS
1830	607205.61	1118042.11	584.16	HOR	1913	607232.67	1117907.66	590.10	AC
1831	607206.05	1118042.13	584.00	DLN	1914	607239.02	1117891.12	590.87	AC
1832	607207.54	1118042.34	584.83		1915	607238.36	1117890.94	590.77	SS
1833	607209.89	1118030.39	585.26		1916	607236.92	1117890.22	591.45	
1834	607208.10	1118029.64	584.40	DLN	1917	607241.63	1117891.57	590.89	
1835	607207.72	1118029.43	584.58	HOR	1918	607244.56	1117892.79	590.87	BET
1836	607207.35	1118029.34	584.59	BET	1919	607244.88	1117892.86	590.84	HOR
1837	607204.40	1118029.22	584.68		1920	607245.33	1117892.87	590.69	DLN
1838	607201.44	1118028.87	584.67	AC	1921	607246.67	1117893.47	591.60	
1839	607201.08	1118028.83	584.63	VS	1922	607252.50	1117878.18	592.37	
1840	607200.41	1118028.73	584.44	SS	1923	607251.09	1117877.77	591.43	DLN
1841	607199.24	1118028.49	584.69		1924	607250.55	1117877.37	591.59	HOR
1842	607202.65	1118012.25	585.33		1925	607250.35	1117877.30	591.62	BET
1843	607203.84	1118012.92	585.03	SS	1926	607247.63	1117876.42	591.64	
1844	607204.26	1118012.96	585.10	VS	1927	607244.58	1117875.46	591.54	AC
1845	607204.59	1118013.05	585.13	AC	1928	607244.02	1117875.29	591.54	SS
1846	607207.30	1118013.31	585.19		1929	607242.65	1117874.80	591.94	
1847	607212.63	1118014.14	585.57		1930	607248.45	1117859.27	592.45	
1848	607211.17	1118013.93	584.95	DLN	1931	607249.96	1117859.61	591.98	SS
1849	607210.73	1118013.84	585.04	HOR	1932	607250.63	1117859.68	592.02	AC
1850	607210.39	1118013.86	585.10	BET	1933	607253.45	1117860.55	592.11	
1851	607213.98	1117996.89	585.61	BET	1934	607256.39	1117861.14	592.03	BET
1852	607214.30	1117996.75	585.56	HOR	1935	607256.76	1117861.22	592.00	HOR
1853	607214.85	1117996.70	585.39	DLN	1936	607257.11	1117861.27	591.94	DLN
1854	607216.57	1117997.26	586.30		1937	607258.52	1117861.54	592.70	
1855	607211.49	1117995.93	585.67		1938	607262.69	1117850.71	593.01	
1856	607205.98	1117994.38	585.93		1939	607261.17	1117850.35	592.18	DLN
1857	607207.35	1117994.97	585.43	SS	1940	607260.92	1117850.30	592.28	HOR
1858	607207.83	1117994.99	585.57	VS	1941	607260.47	1117850.27	592.32	BET
1859	607208.30	1117995.02	585.66	AC	1942	607257.93	1117848.83	592.42	
1860	607211.38	1117981.11	586.20	AC	1943	607255.19	1117847.69	592.30	AC
1861	607211.03	1117981.08	586.14	VS	1944	607254.64	1117847.65	592.31	SS
1862	607210.34	1117980.99	585.98	SS	1945	607253.48	1117847.28	592.66	
1863	607208.87	1117980.66	586.41		1946	607259.41	1117830.66	592.99	
1864	607214.27	1117981.38	586.33		1947	607260.67	1117831.20	592.68	SS
1865	607217.55	1117981.46	586.23	BET	1948	607261.19	1117831.44	592.69	AC
1866	607217.76	1117981.40	586.20	HOR	1949	607264.04	1117832.22	592.83	
1867	607218.39	1117981.54	586.06	DLN	1950	607266.70	1117833.36	592.75	BET
1868	607219.99	1117981.84	586.78		1951	607267.01	1117833.49	592.74	HOR
1869	607223.84	1117967.56	587.58		1952	607267.41	1117833.68	592.58	DLN
1870	607222.07	1117966.66	586.74	DLN	1953	607268.75	1117834.32	593.32	
1871	607221.51	1117966.54	586.92	HOR	1954	607275.13	1117816.40	593.56	
1872	607221.20	1117966.46	586.98	BET	1955	607274.01	1117816.37	593.00	DLN
1873	607218.40	1117965.84	587.08		1956	607273.52	1117815.94	593.19	HOR
1874	607215.39	1117965.14	587.10	AC	1957	607273.31	1117815.68	593.21	BET
1875	607214.98	1117965.05	587.01	VS	1958	607270.44	1117814.84	593.26	
1876	607214.17	1117964.81	586.75	SS	1959	607267.69	1117813.90	593.17	AC
1877	607212.46	1117964.66	586.98		1960	607266.98	1117813.70	593.17	SS
1878	607215.49	1117950.87	588.09		1961	607265.62	1117813.24	593.33	
1879	607217.60	1117951.26	587.63	SS	1962	607271.31	1117798.17	593.76	
1880	607218.49	1117951.41	587.85	VS	1963	607272.75	1117798.45	593.59	
1881	607218.96	1117951.34	587.93	AC	1964	607273.49	1117798.74	593.54	AC
1882	607221.85	1117951.90	587.90		1965	607276.00	1117799.64	593.59	
1883	607224.84	1117952.56	587.80	BET	1966	607278.88	1117800.32	593.55	BET
1884	607225.11	1117952.56	587.78	HOR	1967	607279.22	1117800.45	593.53	HOR
1885	607225.69	1117952.67	587.66	DLN	1968	607279.64	1117800.48	593.42	DLN
1886	607227.21	1117952.99	588.39		1969	607280.69	1117800.75	593.92	
1887	607230.02	1117941.09	589.45		1970	607283.45	1117794.33	593.97	
1888	607228.76	1117940.82	588.52	DLN	1971	607282.27	1117793.98	593.64	DLN
1889	607228.54	1117940.65	588.56	HOR	1972	607281.60	1117793.71	593.65	HOR
1890	607228.21	1117940.62	588.59	BET	1973	607281.31	1117793.38	593.66	BET XNEJ
1891	607225.10	1117939.82	588.69		1974	607281.92	1117792.36	593.67	NEJ
1892	607222.42	1117939.00	588.61	AC	1975	607282.75	1117791.62	593.76	NEJ
1893	607222.07	1117938.98	588.55	VS	1976	607283.71	1117791.63	593.81	NEJ
1894	607221.32	1117938.53	588.41	SS	1977	607284.93	1117792.11	593.89	NEJ
1895	607220.05	1117938.37	588.70		1978	607283.18	1117788.37	593.76	BET XNEJ
1896	607224.23	1117923.66	589.80		1979	607286.23	1117789.54	593.97	NEJ
1897	607225.81	1117923.82	589.25	SS	1980	607275.99	1117791.89	593.65	AC XNEJ
1898	607226.77	1117923.76	589.46	VS	1981	607275.64	1117788.26	593.70	NEJ
1899	607227.14	1117923.73	589.50	AC	1982	607273.22	1117784.74	593.65	NEJ
1900	607229.67	1117924.39	589.54		1983	607279.66	1117781.65	593.84	AC XNEJ
1901	607232.97	1117925.02	589.48	BET	1984	607277.96	1117782.30	593.80	NEJ
1902	607233.16	1117925.20	589.44	HOR	1985	607275.95	1117782.08	593.78	NEJ
1903	607233.39	1117925.43	589.32	DLN	1986	607274.36	1117781.68	593.73	NEJ
1904	607234.62	1117925.65	590.16		1987	607133.36	1118799.45	563.60	
1905	607240.94	1117909.69	591.16		1988	607112.61	1118897.34	559.41	
1906	607239.05	1117909.77	589.95	DLN	1989	607088.74	1119117.14	551.70	XAC2
1907	607238.37	1117909.81	590.12	HOR	1990	607088.84	1119116.91	551.75	XAC
1908	607238.19	1117909.77	590.11	BET	1991	607088.88	1119116.74	551.88	XAC1
1909	607235.47	1117908.57	590.24		1992	607088.04	1119118.26	551.72	SOUPAK

č.bodu	Y	X	Z	popis	č.bodu	Y	X	Z	popis
1993	607088.86	1119118.67	551.75	SOUPAK	2076	607130.11	1119166.67	551.12	BET1
1994	607089.87	1119119.93	551.79	HYDRANT	2077	607130.25	1119166.68	550.97	BET
1995	607086.72	1119119.31	551.80		2078	607130.50	1119166.69	550.98	BET2
1996	607081.00	1119119.29	551.81	ZNACKA	2079	607130.05	1119167.97	550.89	BET2
1997	607084.05	1119121.07	551.84	XBET2	2080	607129.85	1119167.70	550.86	BET
1998	607083.87	1119121.25	551.83	XBET	2081	607129.70	1119167.63	551.02	BET1
1999	607083.85	1119121.47	551.97	XBET1	2082	607129.20	1119168.41	551.07	BET1
2000	607092.19	1119128.69	551.90	BET2	2083	607128.48	1119169.14	550.84	BET1
2001	607091.84	1119128.72	551.91	BET	2084	607129.58	1119168.67	550.88	BET2
2002	607091.67	1119128.81	552.08	BET1	2085	607129.31	1119168.48	550.92	BET2 BET
2003	607092.42	1119129.46	551.95	BET1 XCES	2086	607128.13	1119164.24	551.19	SKRUH
2004	607091.10	1119130.83	551.59	CES	2087	607128.77	1119163.77	551.38	HYDRANT
2005	607095.73	1119132.59	551.92	BET1 XCES	2088	607127.13	1119162.76	551.41	ZNACKA
2006	607094.36	1119134.01	551.67	CES	2089	607131.88	1119154.35	551.68	ZNACKA
2007	607096.39	1119133.24	552.02	BET1	2090	607133.77	1119160.93	551.45	
2008	607096.51	1119133.17	551.86	BET	2091	607128.39	1119157.02	551.55	
2009	607096.74	1119133.02	551.89	BET2	2092	607124.69	1119154.18	551.61	
2010	607096.67	1119133.85	552.00	SKRUH	2093	607119.11	1119149.41	551.70	
2011	607092.52	1119129.92	551.83	SOUPAK	2094	607114.19	1119144.97	551.79	
2012	607093.30	1119126.05	551.89		2095	607110.92	1119141.98	551.83	
2013	607095.54	1119123.53	551.85	AC2	2096	607106.41	1119137.64	551.90	
2014	607095.70	1119123.36	551.85	AC	2097	607108.11	1119135.23	551.84	AC2
2015	607095.78	1119123.23	551.99	AC1	2098	607108.23	1119135.02	551.84	AC
2016	607101.05	1119128.17	552.02	AC1	2099	607108.33	1119134.94	551.97	AC1
2017	607100.87	1119128.18	551.90	AC	2100	607113.45	1119139.71	551.92	AC1
2018	607100.67	1119128.36	551.90	AC2	2101	607113.35	1119139.81	551.78	AC
2019	607098.63	1119130.58	551.93		2102	607113.17	1119139.95	551.78	AC2
2020	607102.00	1119133.50	551.91		2103	607111.17	1119139.49	551.78	SOUPAK
2021	607101.69	1119130.65	551.87	SOUPAK	2104	607116.53	1119143.04	551.73	AC2
2022	607103.80	1119131.26	551.86	AC2	2105	607116.69	1119142.89	551.71	AC
2023	607103.96	1119131.08	551.87	AC	2106	607116.71	1119142.76	551.85	AC1
2024	607101.78	1119128.85	551.96	AC1	2107	607119.65	1119145.30	551.83	AC1
2025	607103.23	1119130.21	551.98	AC1	2108	607120.41	1119145.95	551.75	AC1
2026	607103.98	1119130.91	552.04	AC1	2109	607120.29	1119146.06	551.67	AC
2027	607100.05	1119136.20	551.84	BET2	2110	607120.11	1119146.26	551.68	AC2
2028	607100.24	1119136.37	551.88	BET2	2111	607121.71	1119147.10	551.74	AC1
2029	607100.07	1119136.55	551.88	BET	2112	607121.93	1119147.29	551.76	AC1 XCES
2030	607099.99	1119136.65	552.01	BET1	2113	607122.31	1119147.64	551.79	AC1
2031	607103.81	1119140.23	552.01	BET1	2114	607122.20	1119147.73	551.63	AC
2032	607103.89	1119140.09	551.81	BET	2115	607122.00	1119147.90	551.66	AC2
2033	607104.05	1119139.88	551.83	BET2	2116	607122.79	1119146.05	551.73	CES
2034	607104.55	1119140.91	551.87	BET1 XCES	2117	607131.14	1119151.67	551.55	CES
2035	607103.12	1119142.44	551.51	CES	2118	607123.46	1119148.62	551.78	AC1
2036	607108.14	1119144.28	551.85	BET1 XCES	2119	607123.37	1119148.74	551.62	AC
2037	607106.60	1119145.81	551.39	CES	2120	607123.20	1119148.91	551.62	AC2
2038	607108.90	1119144.97	551.93	BET1	2121	607122.25	1119148.23	551.65	SOUPAK
2039	607109.12	1119144.71	551.78	BET2	2122	607127.26	1119152.09	551.61	AC2
2040	607108.97	1119144.87	551.76	BET	2123	607127.40	1119151.86	551.60	AC
2041	607111.37	1119147.13	551.72	BET	2124	607127.53	1119151.80	551.70	AC1
2042	607111.53	1119146.94	551.74	BET2	2125	607128.17	1119151.10	551.69	PRISKA
2043	607111.09	1119147.07	551.87	BET1	2126	607131.84	1119154.90	551.64	AC1
2044	607111.87	1119147.80	551.73	BET1 XCES	2127	607131.80	1119155.01	551.48	AC
2045	607110.31	1119149.42	551.29	CES	2128	607131.67	1119155.27	551.52	AC2
2046	607115.52	1119151.20	551.70	BET1 XCES	2129	607135.69	1119158.06	551.43	AC2
2047	607113.82	1119152.86	551.20	CES	2130	607135.57	1119157.66	551.40	AC
2048	607116.29	1119151.93	551.79	BET1	2131	607137.45	1119155.89	551.48	CES
2049	607116.35	1119151.81	551.64	BET	2132	607136.09	1119157.86	551.52	AC1 CES
2050	607116.52	1119151.64	551.64	BET2	2133	607136.49	1119158.15	551.49	AC1
2051	607122.35	1119156.99	551.51	BET2	2134	607138.13	1119159.26	551.42	AC1
2052	607122.16	1119157.21	551.50	BET	2135	607138.47	1119159.48	551.44	AC1 XCES
2053	607121.81	1119157.05	551.67	BET1 XSCH	2136	607139.82	1119157.45	551.48	CES
2054	607119.99	1119158.91	551.05	SCH	2137	607138.43	1119159.61	551.31	AC
2055	607120.71	1119159.59	551.01	SCH	2138	607138.28	1119159.82	551.34	AC2
2056	607122.56	1119157.76	551.60	BET1 SCH	2139	607138.13	1119159.81	551.33	SOUPAK
2057	607125.68	1119160.07	551.42	BET2 XJOB	2140	607140.16	1119157.68	551.47	PSOUPAK
2058	607125.73	1119160.03	551.40	JOB	2141	607146.28	1119163.41	551.41	SKRUH
2059	607125.51	1119160.27	551.39	BET	2142	607144.67	1119162.75	551.42	ZNACKA
2060	607125.41	1119160.38	551.56	BET1	2143	607148.37	1119162.99	551.33	CES
2061	607127.36	1119162.26	551.47	BET1	2144	607150.62	1119164.20	551.30	CES
2062	607127.47	1119162.13	551.31	BET	2145	607149.69	1119166.83	551.12	SOUPAK
2063	607127.64	1119161.93	551.29	BET2 XWAY	2146	607146.47	1119165.41	551.11	VPUST
2064	607127.71	1119161.82	551.29	WAY	2147	607142.13	1119162.50	551.28	AC2
2065	607129.52	1119163.17	551.25	WAY	2148	607142.23	1119162.21	551.32	AC
2066	607129.75	1119163.04	551.26	JOB	2149	607142.28	1119162.10	551.43	AC1
2067	607128.97	1119163.18	551.25	BET2	2150	607146.16	1119164.65	551.37	AC1
2068	607128.91	1119163.48	551.26	BET	2151	607146.14	1119164.79	551.17	AC
2069	607128.82	1119163.57	551.40	BET1	2152	607145.99	1119165.03	551.17	AC2
2070	607129.75	1119164.73	551.33	BET1	2153	607149.55	1119167.10	551.13	AC2
2071	607129.84	1119164.65	551.15	BET	2154	607149.37	1119166.70	551.13	AC
2072	607130.10	1119164.52	551.17	BET2	2155	607149.37	1119166.55	551.29	AC1 CES
2073	607130.54	1119165.55	551.12	BET2	2156	607149.27	1119165.67	551.32	LLAMPA
2074	607130.28	1119165.59	551.12	BET	2157	607150.64	1119167.27	551.28	AC1
2075	607130.14	1119165.66	551.25	BET1	2158	607151.68	1119167.81	551.18	AC1

č.bodu	Y	X	Z	popis	č.bodu	Y	X	Z	popis
2159	607151.62	1119167.95	551.12	AC	2242	607201.35	1119183.26	550.16	AC1
2160	607151.49	1119168.24	551.13	AC2	2243	607201.32	1119183.41	550.02	AC
2161	607149.50	1119171.16	551.10		2244	607201.19	1119183.62	549.98	AC2
2162	607133.41	1119165.70	551.16	JOB	2245	607200.08	1119182.60	550.27	AUTOBUS
2163	607133.26	1119165.95	551.15	WAY	2246	607192.70	1119185.16	549.79	FIE2
2164	607135.09	1119170.46	550.75	VPUST	2247	607192.47	1119185.66	549.78	FIE
2165	607137.85	1119172.77	550.77		2248	607191.32	1119189.30	549.81	
2166	607139.70	1119170.28	551.05	WAY	2249	607189.32	1119193.47	549.73	JOB
2167	607139.87	1119170.10	551.05	JOB	2250	607189.21	1119193.70	549.73	WAY
2168	607140.33	1119165.73	551.29		2251	607183.06	1119192.96	549.99	CES XZID
2169	607132.70	1119160.27	551.47		2252	607183.02	1119193.08	550.10	CES1
2170	607148.20	1119175.23	550.87	JOB	2253	607183.27	1119193.37	550.20	XZID1
2171	607148.07	1119175.50	550.85	WAY	2254	607189.12	1119195.59	550.02	ZID1
2172	607146.31	1119179.11	550.54		2255	607189.54	1119195.42	549.67	ZID
2173	607154.33	1119183.40	550.42		2256	607189.61	1119195.73	549.70	ZNACKA
2174	607156.22	1119179.98	550.68	WAY	2257	607187.46	1119200.94	549.96	ZID1
2175	607156.33	1119179.70	550.71	JOB	2258	607187.79	1119201.01	549.59	ZID
2176	607157.99	1119176.14	550.95		2259	607195.45	1119203.31	549.17	
2177	607159.45	1119172.54	550.99	AC2	2260	607198.28	1119196.97	549.24	WAY
2178	607159.63	1119172.24	551.00	AC	2261	607198.40	1119196.73	549.23	JOB
2179	607159.64	1119172.09	551.03	AC1	2262	607200.32	1119192.81	549.26	
2180	607155.25	1119166.63	551.15	XCES	2263	607201.63	1119188.99	549.17	FIE
2181	607157.33	1119167.71	551.14	CES	2264	607201.86	1119188.47	549.19	FIE2
2182	607163.37	1119173.95	550.94	AC1	2265	607206.42	1119185.33	549.62	AC2
2183	607163.36	1119174.08	550.89	AC	2266	607206.29	1119185.01	549.63	AC
2184	607163.39	1119174.38	550.90	AC2 XFIE	2267	607204.34	1119184.26	549.93	AC1
2185	607164.06	1119174.07	550.89	AC2 XFIE2	2268	607205.28	1119184.54	549.75	AC1
2186	607167.71	1119172.49	550.90	AC2	2269	607207.19	1119185.18	549.62	AC1
2187	607167.69	1119172.19	550.93	AC	2270	607208.13	1119185.51	549.65	AC1
2188	607167.65	1119172.00	551.10	CES AC1	2271	607208.87	1119185.54	549.58	LLAMPA
2189	607165.92	1119172.29	550.95	SOUPAK	2272	607219.15	1119189.17	548.78	AC1
2190	607170.56	1119172.78	551.04	LLAMPA	2273	607219.00	1119189.28	548.64	AC
2191	607173.86	1119174.05	550.99	AC1	2274	607218.90	1119189.53	548.65	AC2
2192	607174.32	1119174.23	550.91	AC1	2275	607216.92	1119193.77	548.16	FIE2
2193	607176.11	1119174.81	550.87	AC1	2276	607216.70	1119194.31	548.13	FIE
2194	607176.59	1119174.98	550.96	AC1	2277	607217.20	1119194.19	548.07	VPUST
2195	607175.39	1119174.68	550.83	AC	2278	607215.63	1119198.10	548.23	
2196	607175.39	1119174.98	550.83	AC2	2279	607208.76	1119195.72	548.71	
2197	607177.19	1119176.23	550.77	SOUPAK	2280	607202.79	1119203.78	548.88	XBET2
2198	607172.90	1119177.60	550.67	FIE2	2281	607202.98	1119203.95	548.86	XBET
2199	607172.74	1119178.10	550.65	FIE	2282	607203.10	1119204.03	549.01	XBET1
2200	607171.33	1119181.72	550.70		2283	607203.66	1119203.20	548.99	BET1
2201	607162.33	1119177.75	550.89		2284	607203.53	1119203.17	548.84	BET
2202	607160.47	1119181.71	550.64	JOB	2285	607203.37	1119202.93	548.85	BET2
2203	607160.34	1119181.92	550.61	WAY	2286	607204.52	1119201.83	548.81	BET2
2204	607158.74	1119186.02	550.33		2287	607204.68	1119202.05	548.77	BET
2205	607163.78	1119187.76	550.29	XCES	2288	607204.78	1119202.11	548.90	BET1
2206	607163.92	1119187.79	550.36	XCES1	2289	607204.88	1119202.42	548.93	ZNACKA
2207	607165.12	1119187.04	550.44	CES1	2290	607205.97	1119201.31	548.78	BET1
2208	607165.10	1119186.93	550.39	CES	2291	607205.92	1119201.20	548.73	BET
2209	607165.63	1119186.73	550.40	CES	2292	607205.77	1119201.01	548.77	BET2
2210	607165.65	1119186.86	550.45	CES1	2293	607206.80	1119200.55	548.69	BET2
2211	607166.32	1119186.78	550.49	CES1	2294	607206.88	1119200.80	548.69	BET
2212	607166.31	1119186.65	550.41	CES	2295	607206.91	1119200.93	548.70	BET1
2213	607167.15	1119186.83	550.43	CES	2296	607207.91	1119200.78	548.66	BET1
2214	607167.11	1119186.97	550.48	CES1	2297	607207.88	1119200.66	548.63	BET
2215	607168.05	1119185.44	550.51	WAY	2298	607207.85	1119200.38	548.62	BET2
2216	607168.21	1119185.22	550.53	JOB	2299	607208.45	1119200.38	548.59	BET2 WAY
2217	607178.21	1119189.34	550.25	JOB	2300	607208.99	1119200.43	548.55	BET2 JOB
2218	607178.08	1119189.54	550.25	WAY	2301	607209.43	1119200.52	548.53	BET2
2219	607177.77	1119190.92	550.19	CES	2302	607208.94	1119200.68	548.55	BET
2220	607177.70	1119191.04	550.26	CES1	2303	607209.45	1119200.82	548.51	BET
2221	607179.88	1119185.23	550.41		2304	607208.95	1119200.83	548.67	BET1
2222	607181.05	1119181.45	550.39	FIE	2305	607209.39	1119200.94	548.65	BET1
2223	607181.30	1119180.92	550.39	FIE2	2306	607211.21	1119201.56	548.61	BET1
2224	607181.48	1119181.32	550.36	VPUST	2307	607211.54	1119201.55	548.41	BET
2225	607182.58	1119177.41	550.74	AC2	2308	607212.15	1119201.49	548.34	BET2 XJOB
2226	607182.63	1119177.14	550.77	AC	2309	607211.90	1119201.65	548.38	BET2 XWAY
2227	607182.64	1119177.02	550.91	AC1	2310	607209.33	1119201.71	548.71	ZNACKA
2228	607183.20	1119176.99	550.88	AUTOBUS	2311	607206.37	1119204.62	548.75	BET2
2229	607187.05	1119179.68	550.55	HYDRANT	2312	607205.68	1119204.66	548.82	BET
2230	607186.86	1119178.87	550.66	AC2	2313	607205.34	1119204.69	548.98	BET1
2231	607186.92	1119178.60	550.68	AC	2314	607213.10	1119207.48	548.38	BET1
2232	607185.66	1119177.98	550.80	AC1	2315	607213.11	1119207.32	548.25	BET
2233	607186.18	1119178.15	550.73	AC1	2316	607213.20	1119207.06	548.24	BET2
2234	607188.09	1119178.80	550.65	AC1	2317	607214.71	1119202.61	548.17	WAY
2235	607188.59	1119178.94	550.66	AC1	2318	607214.83	1119202.39	548.18	JOB
2236	607188.90	1119178.68	550.76	SLIST	2319	607223.50	1119211.12	547.59	BET1
2237	607191.30	1119179.63	550.66	LLAMPA	2320	607223.63	1119211.00	547.47	BET
2238	607196.16	1119182.26	550.25	SOUPAK	2321	607223.71	1119210.76	547.48	BET2
2239	607199.60	1119183.74	550.01	SOUPAK	2322	607225.32	1119206.29	547.47	WAY
2240	607200.55	1119184.17	549.90	SOUPAK	2323	607225.46	1119206.03	547.47	JOB
2241	607201.75	1119185.07	549.79	SOUPAK	2324	607226.66	1119202.33	547.46	

č.bodu	Y	X	Z	popis	č.bodu	Y	X	Z	popis
2325	607228.22	1119198.42	547.32	FIE	2408	607246.67	1119204.49	545.74	AC1
2326	607228.51	1119197.90	547.35	FIE2	2409	607248.57	1119205.06	545.58	AC1
2327	607229.83	1119193.23	547.78	AC2	2410	607248.53	1119205.22	545.55	AC
2328	607229.60	1119192.86	547.83	AC	2411	607248.43	1119205.45	545.58	AC2
2329	607227.68	1119192.06	548.10	AC1	2412	607249.40	1119205.72	545.48	AC2
2330	607227.19	1119191.66	548.15	LLAMPA	2413	607249.48	1119205.46	545.45	AC
2331	607230.43	1119192.99	547.88	XAC1	2414	607249.54	1119205.34	545.49	AC1
2332	607235.66	1119196.76	547.22	SKRUH	2415	607250.49	1119205.54	545.55	AC1
2333	607239.38	1119195.82	547.32	ZNACKA	2416	607250.46	1119205.68	545.43	AC
2334	607239.55	1119196.03	547.32	AC1	2417	607250.37	1119205.93	545.43	AC2
2335	607239.48	1119196.18	547.14	AC	2418	607251.31	1119206.11	545.38	AC2
2336	607239.43	1119196.43	547.16	AC2	2419	607251.35	1119205.86	545.35	AC
2337	607244.55	1119196.86	546.66	AC2	2420	607251.36	1119205.71	545.51	AC1
2338	607244.92	1119196.66	546.68	AC	2421	607251.29	1119204.98	545.56	ZNACKA
2339	607245.12	1119196.54	546.81	AC1	2422	607252.39	1119205.83	545.43	AC1
2340	607242.59	1119202.97	546.29	AC1	2423	607252.33	1119205.97	545.28	AC
2341	607242.44	1119202.87	546.25	AC FIE2	2424	607252.34	1119206.21	545.30	AC2
2342	607242.40	1119203.07	546.22	AC XAC2	2425	607254.07	1119206.31	545.16	AC2
2343	607242.32	1119203.29	546.23	AC2 FIE	2426	607254.07	1119206.05	545.17	AC
2344	607242.23	1119203.46	546.23	XNEJ	2427	607254.06	1119205.91	545.33	AC1
2345	607240.86	1119207.25	546.22	NEJ	2428	607255.05	1119205.82	545.29	AC1
2346	607239.70	1119210.99	546.15	NEJ JOB	2429	607255.09	1119205.95	545.13	AC
2347	607234.24	1119214.87	546.81	BET1	2430	607255.09	1119206.18	545.15	AC2
2348	607234.21	1119214.72	546.70	BET	2431	607256.08	1119205.95	545.10	AC2
2349	607234.17	1119214.43	546.72	BET2	2432	607256.06	1119205.70	545.08	AC
2350	607239.96	1119211.45	546.15	BET2	2433	607256.03	1119205.55	545.24	AC1
2351	607239.87	1119211.19	546.14	JOB	2434	607257.40	1119205.04	545.17	AC1
2352	607240.03	1119211.37	546.14	BET2 WAY	2435	607257.52	1119205.15	545.03	AC
2353	607240.08	1119211.26	546.14	BET2	2436	607257.59	1119205.37	545.05	AC2
2354	607243.14	1119212.28	545.87	BET2	2437	607258.22	1119205.06	545.03	VPUST
2355	607242.98	1119212.46	545.87	BET	2438	607258.53	1119204.87	545.03	AC2
2356	607242.95	1119212.62	546.01	BET1	2439	607259.35	1119204.28	545.04	AC2
2357	607243.88	1119212.95	545.79	BET1	2440	607258.37	1119204.69	545.02	AC
2358	607243.93	1119212.82	545.75	BET	2441	607259.17	1119204.11	545.02	AC
2359	607244.05	1119212.60	545.76	BET2	2442	607258.29	1119204.56	545.16	AC1
2360	607244.95	1119212.94	545.64	BET2	2443	607259.08	1119203.99	545.18	AC1
2361	607245.86	1119213.33	545.56	BET2	2444	607259.80	1119203.31	545.16	AC1
2362	607244.89	1119213.19	545.63	BET	2445	607259.93	1119203.40	545.01	AC
2363	607245.78	1119213.57	545.53	BET	2446	607260.09	1119203.59	545.01	AC2
2364	607244.82	1119213.33	545.67	BET1	2447	607261.47	1119202.16	545.01	AC2
2365	607245.71	1119213.68	545.56	BET1	2448	607261.31	1119201.96	545.02	AC
2366	607246.63	1119214.09	545.47	BET1	2449	607261.20	1119201.87	545.15	AC1
2367	607247.50	1119214.62	545.44	BET1	2450	607261.84	1119201.10	545.14	AC1
2368	607246.70	1119213.98	545.44	BET	2451	607261.95	1119201.21	545.01	AC
2369	607246.81	1119213.76	545.47	BET2	2452	607262.16	1119201.37	545.00	AC2
2370	607247.68	1119214.21	545.37	BET2	2453	607262.76	1119200.55	545.00	AC2
2371	607247.57	1119214.39	545.38	BET	2454	607262.58	1119200.40	545.01	AC
2372	607248.93	1119215.35	545.18	BET	2455	607262.45	1119200.32	545.17	AC1
2373	607249.12	1119215.16	545.19	BET2	2456	607262.70	1119199.88	545.20	AC1
2374	607248.88	1119215.47	545.34	BET1	2457	607262.81	1119199.97	545.03	AC
2375	607250.33	1119216.79	545.14	BET1	2458	607263.04	1119200.09	545.02	AC2
2376	607250.47	1119216.70	545.01	BET	2459	607263.46	1119199.17	545.01	AC2
2377	607250.63	1119216.48	545.02	BET2	2460	607263.25	1119199.06	545.03	AC
2378	607251.88	1119218.00	544.90	BET2	2461	607263.11	1119198.97	545.07	AC1
2379	607251.75	1119218.21	544.86	BET	2462	607262.19	1119199.40	545.20	ZNACKA
2380	607251.66	1119218.33	544.97	BET1	2463	607260.32	1119199.65	545.32	ZNACKA
2381	607252.76	1119219.99	544.90	BET1	2464	607261.65	1119200.43	545.13	SOUPAK
2382	607252.91	1119219.91	544.72	BET	2465	607262.44	1119200.09	545.17	SOUPAK
2383	607253.10	1119219.77	544.75	BET2	2466	607261.88	1119201.65	544.99	SOUPAK
2384	607253.55	1119220.71	544.66	BET2	2467	607264.80	1119206.75	544.74	SKRUH
2385	607253.33	1119220.81	544.63	BET	2468	607266.00	1119200.71	544.92	
2386	607253.19	1119220.89	544.77	BET1	2469	607263.89	1119208.07	544.76	
2387	607253.78	1119222.74	544.62	BET1	2470	607261.83	1119214.31	544.55	
2388	607253.94	1119222.76	544.48	BET	2471	607259.53	1119223.26	544.18	
2389	607254.16	1119222.68	544.49	BET2	2472	607257.87	1119229.46	543.74	
2390	607254.42	1119223.88	544.37	BET2 VPUST					
2391	607254.15	1119223.76	544.39	BET					
2392	607254.01	1119223.81	544.53	BET1					
2393	607254.32	1119225.76	544.41	BET1					
2394	607254.44	1119225.69	544.23	BET					
2395	607254.70	1119225.70	544.23	BET2					
2396	607254.75	1119225.33	544.25	SKRUH					
2397	607254.73	1119227.81	544.09	BET2					
2398	607254.49	1119227.72	544.08	BET					
2399	607254.33	1119227.70	544.24	BET1					
2400	607257.04	1119220.66	544.45						
2401	607259.02	1119213.48	544.68						
2402	607261.30	1119205.58	544.91						
2403	607253.00	1119211.16	545.15						
2404	607246.99	1119209.17	545.68						
2405	607246.99	1119205.02	545.70	AC2					
2406	607246.63	1119204.65	545.71	AC					
2407	607245.73	1119204.14	545.97	AC1					

ZAMEŁI:	Ing-Pol / InoC	WYPAKOWAŁ:	Ing-Pol / InoC	 IGH polska inżynieria i handel www.igh.eu pol@igh.eu
KATJEWI:	Odpowiedzialny	Odpowiedzialny	Restacja	
INWESTOR:	MSWiA			

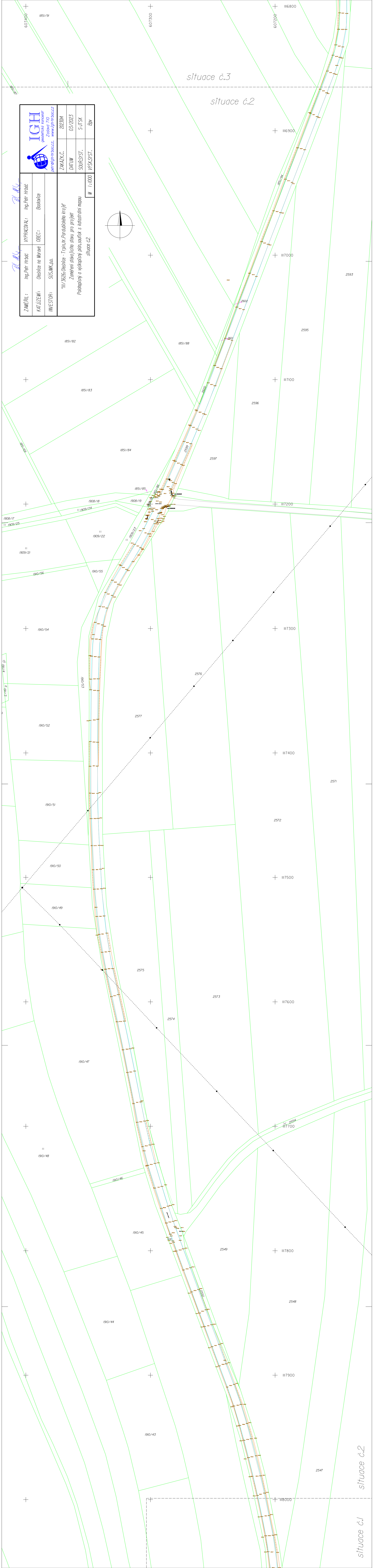

**Náležitostí a přesností odpovídá právním předpisům a podmínkám písemně
dohodnutým s odběratelem.**

Ing. Petr Hrbáč
oprávněn ověřovat výsledky zeměměřických činností
dle § 13 odstavce 1 písmena c) zákona číslo 200/1994 Sbírky

Evidenční číslo ověření: 2545/11
Ve Valašském Meziříčí dne: 03. 03. 2023



14 / 2023